

Catalogue

Integral solutions



TermoExpress is a joinery manufacturer specialized in providing high-quality, high-performance and sustainable heat-insulating solutions for construction companies within Europe!

We manufacture and supply customized solutions for aluminum and PVC windows and doors from Cortizo, a brand recognized worldwide for the quality of its profiles and the reliability of its closing systems. Our collaboration with Cortizo it's not limited to exterior joinery. We offer a wide range of products including roller shutters, curtain walls, sliding glass panels, garage doors and a variety of profiles and accessories.



OVIDIU TOMOIAGA
CEO & Founder TermoExpress

What's in it for you?



Personalized consulting services



Design and production



Direct shipping from our factory

OVER 78.000 mp
produced and marketed

OVER 6000
completed projects



Technical assistance for installation



Manufacturer's Warranty

OVER 3000
satisfied customers

SUMMARY

ALUMINUM PROFILES

- 4 Cor 80 Industrial Passivhaus
- 5 Cor 80 Industrial
- 8 Cor 80 Hidden Sash
- 10 Cor 70 Industrial
- 12 Cor 70 Hidden Sash
- 14 Cor 70 OC
- 15 Cor 70 OC Half- Hidden sash
- 18 Alu-Steel
- 20 Cor 60
- 22 Cor 70 Evolution
- 26 Cor Urban C16
- 28 Cor Galicia Premium C16
- 30 Casement
- 32 Millennium Plus 80 Door
- 33 Millennium Plus 70 Door
- 36 Millennium Plus Pivot Door
- 38 Panelled Door
- 40 Millennium FR Door
- 41 Millennium 2000 Door
- 43 Millennium Sliding Automatic Door
- 44 Monumental Bi-fold Door
- 46 Bi-fold Plus Door
- 47 Bi-fold Door
- 48 Cor Vision Plus
- 52 Cor Vision
- 54 4600 Lift & Slide
- 55 4700 Lift & Slide / Standard Slide
- 57 4900 Sliding
- 59 4200 Sliding
- 61 Bars
- 62 Alu Handles
- 70 Color options for Aluminium joinery

STEEL AND STAINLESS

STEEL PROFILES

- 73 Forster Unico XS Window
- 75 Forster Unico XS Door

PVC PROFILES

- 78 A 84 Passivhaus HI
- 79 A 84 Passivhaus 1.0 Thermally broken / Passivhaus 1.0
- 80 A 84 Hinged
- 83 A 84 Hidden Sash Passivhaus / Hidden Sash
- 84 A 70 Hinged
- 88 Alcover
- 90 C 70 Sliding
- 92 Synego
- 93 Synego Alu covered
- 94 PVC Handles
- 95 Color options for PVC joinery

WOOD PROFILES

- 97 Termo 92
- 98 Termo 78
- 99 Termo 68

SHADING SYSTEMS

- 102 Exterior Blinds
- 103 Majorquine
- 104 Tamiz
- 106 Openhouse Frangisole
- 108 Solar Protection Louvres
- 110 Roller shutters

GLASS FAÇADES

- 115 TP 52

INTERIOR

DIVISION SYSTEM

- 118 PW 80

BALCONIES

- 120 View Crystal / View Crystal Plus Balcony
- 122 Classic Balcony
- 124 Juliet Balcony

GARAGE DOORS

- 129 Roll-up Garage Door
- 130 Sectional Garage Door

PORTE ROYALE

- 131 Porte Royale

ACCESSORIES

- 142 Ventilation Grilles
- 143 Screens for windows

Aluminium Joinery



Certified for the warm-temperate category, this system offers exceptional thermal insulation thanks to its special foams on the frame and sash. With a transmittance value U_w from just 0.66 W/m^2K , it is an ideal solution for buildings with low energy consumption.

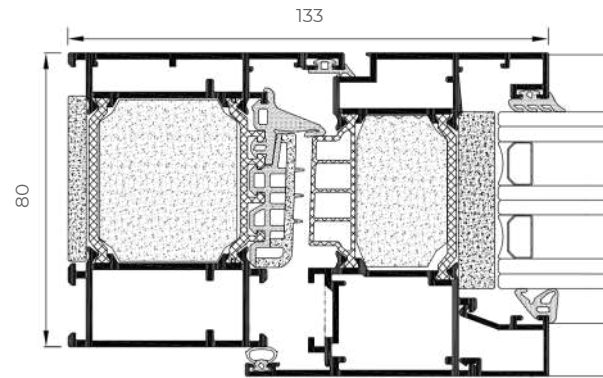

FEATURES

| | | |
|----------------------------|--|------------------------------|
| Transmittance | | $U_w \geq 0.66$ (W/m^2K) |
| Acoustic insulation | | R_w up to 46 dB |
| Air permeability | | Class 4 |
| Water tightness | | Class E1950 |
| Wind resistance | | Class C5 |

Reference test 1.23 x 1.48 m / 2 sashes

POSSIBILITIES



SECURITY
HARDWARE



CONCEALED
HINGES

OPENING POSSIBILITIES

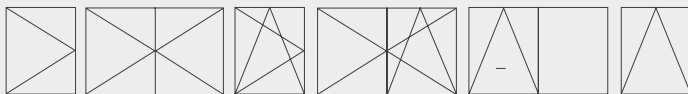

Inward Opening

- Side hung
- Tilt & turn
- Tilt & parallel
- Tilt only



Sightlines

Frame 80 mm, Sash 88 mm

Profile Thickness

1.6 mm

Polyamide Strip Length

45 mm

Glazing

Max. 65 mm, Min. 16 mm

Maximum Sash Dimensions

Width (L) 1500 mm, Height (H) 2600 mm

Maximum Sash Weight

160 kg

Consult maximum weight and dimensions according to typologies.

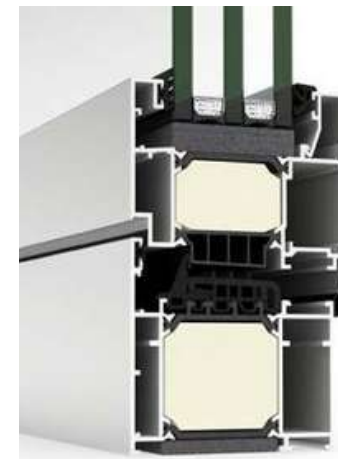

Aesthetic possibilities:

Sash: Straight / Glazing bead: Straight or curved

COR 80

Industrial

With a 80 mm frame depth, the COR 80 Industrial series responds to the most severe climatic requirements thanks to its thermal break with 45 mm tubular polyamide strips and the incorporation of reticulated polyolefin both around the glass and between the frame and sash.

| FEATURES | | |
|---------------------|--|-------------------------------------|
| Transmittance | | $U_w \geq 0.8$ (W/m ² K) |
| Acoustic insulation | | Rw up to 46 dB |
| Air permeability | | Class 4 |
| Water tightness | | Class E1950 |
| Wind resistance | | Class C5 |
| Burglar resistance | | Grade RC2 (WK2) |

Reference test 1.23 x 1.48 m / 2 sashes

ATG 3204

Sightlines

Frame 80 mm, Sash 88 mm

Profile Thickness

1.5 mm

Polyamide Strip Length

45 mm

Glazing

Max. 73 mm, Min. 16 mm

Maximum Sash Dimensions

Width (L) 1500 mm, Height (H) 2600 mm

Maximum Sash Weight

160 kg

Consult maximum weight and dimensions according to typologies.

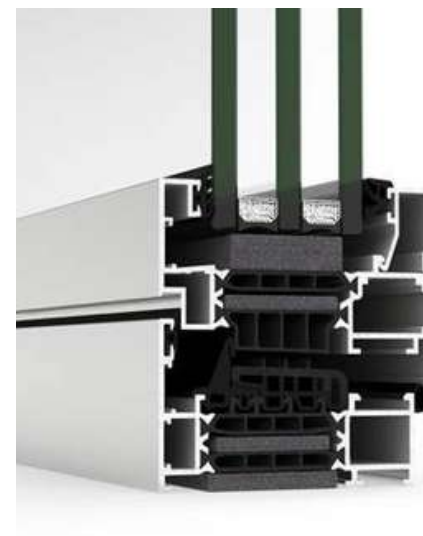

Aesthetic possibilities:

Sash: Straight / Bead: Straight or curved

POSSIBILITIES



SECURITY HARDWARE



CONCEALED HINGES



CONCEALED DRAINAGE



ACCESSIBILITY

OPENING POSSIBILITIES

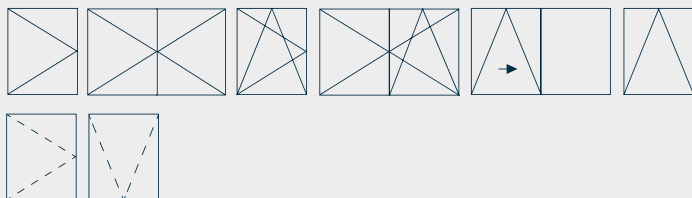

Inward Opening

Side hung
Tilt & turn
Tilt & parallel
Tilt only

Outward Opening

Side hung
Top hung

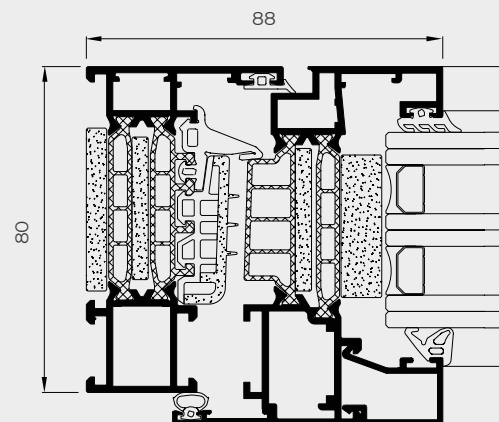



COR 80 INDUSTRIAL



CORTIZO

MINIMALIST HANDLE

Simple lines, avant-garde design

Straight aesthetic

Design without escutcheon

Applicable to all European-Groove hinged series,
C16 series and PVC

Specific transmission box (In European-Groove)

Hidden screws

8 mm spindle (In European-Groove)

Dimensions 32 x 148 mm

COR 80

Hidden Sash



Elegant design with straight aesthetic in which the sash is concealed behind the frame, thus maximizing the glazed surface and the entry of light. In addition, it offers a great thermal and acoustic performance prompted by the 45 mm thermal break and a glazing capacity of up to 51 mm that allows the installation of triple glazing.

FEATURES

| | | |
|---------------------|--|-------------------------------------|
| Transmittance | | $U_w \geq 0.8$ (W/m ² K) |
| Acoustic insulation | | Rw up to 46 dB |
| Air permeability | | Class 4 |
| Water tightness | | Class E1650 |
| Wind resistance | | Class C5 |

Reference test 1.23 x 1.48 m / 2 sashes



Sightlines

Frame 80 mm, Sash 80 mm

Polyamide Strip Length

45 mm

Profile Thickness

Window 1.9 mm

Glazing

Max. 51 mm, Min. 36 mm

Maximum Sash Dimensions

Standard Solution:

Width (L) 1300 mm, Height (H) 2400 mm

HD Hinges (Side Hung):

Width (L) 1200 mm, Height (H) 3500 mm

Maximum Sash Weight

160 kg

POSSIBILITIES



SECURITY HARDWARE



CONCEALED HINGES



CONCEALED HANDLE



CONCEALED DRAINAGE

OPENING POSSIBILITIES

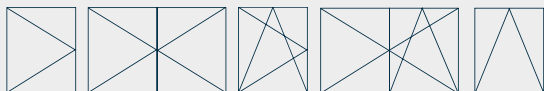

Inward Opening

Side hung
Tilt & turn
Tilt only

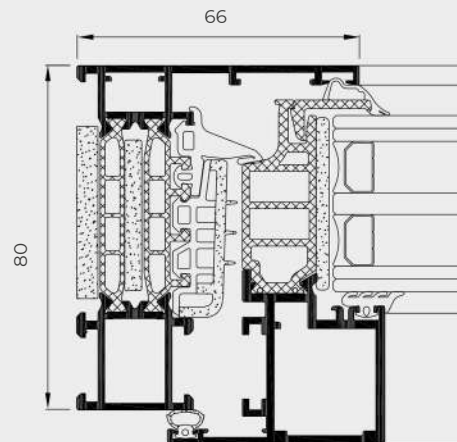

First **invisible handle** on the market



Solution for hidden sash systems **COR 80 HS, COR 70 HS and COR 70 OC**

Dimensions: **27.5 mm (L) x 234 mm (H)**

Ergonomics, robustness and easy handling in opening and closing operations.
Totally clean aesthetics that simulate a fixed element, when in fact, it is a side hung or tilt & turn opening.



Exclusive handle integrated within the sash, **imperceptible from a frontal view.**

Possibility of concealed hinges that consolidates the aesthetic purity of the system.

COR 70

Industrial



This 70 mm frame depth hinged system offers great thermal and acoustic performance combined with very simple fabrication, which is why it has become one of the most demanded series for aluminium windows, doors and balconies.

FEATURES

| | | |
|---------------------|--|-------------------------------------|
| Transmittance | | $U_w \geq 0.9$ (W/m ² K) |
| Acoustic insulation | | Rw up to 44 dB |
| Air permeability | | Class 4 |
| Water tightness | | Class E1800 |
| Wind resistance | | Class C5 |
| Burglar resistance | | Grade RC2 (WK2) |
| Security test | | Passed |

Reference test 1.23 x 1.48 m / 2 sashes
 Security test: Reference test 1.100 x 2.400 m / 1 sash
 Burglar test 1.47 x 2.52 m / 1 sash with EVO SECURITY hardware CSTB Laboratory DTA Certification



* Concealed drainage solution



POSSIBILITIES



OPENING POSSIBILITIES

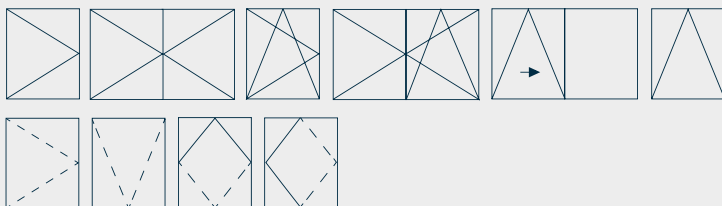

Inward Opening

Side hung
Tilt & turn
Tilt & parallel
Tilt only

Outward Opening

Side hung
Top hung
Pivoting on horizontal or vertical axis

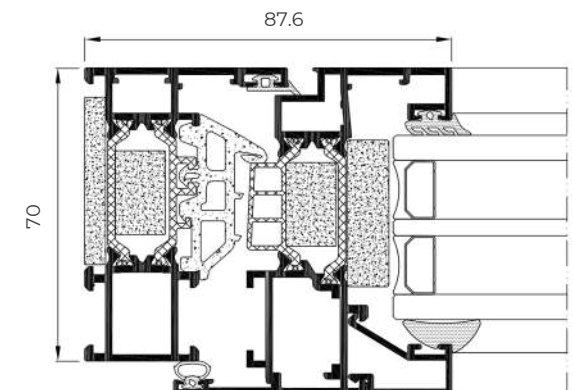

COR 70 INDUSTRIAL



Sightlines

Frame 70 mm, Sash 78 mm

Polyamide Strip Length

From 32 - 35 mm

Profile Thickness

Window 1.5 mm

Door 1.7 mm

Glazing

Max. 63 mm, Min. 6 mm

Maximum Sash Dimensions

Width (L) 1500 mm, Height (H) 2600 mm

Maximum Sash Weight

160 kg

Aesthetic possibilities:

Sash: Straight / Glazing bead: Straight or curved

Consult maximum weight and dimensions according to typologies

COR 70

Hidden Sash



It could be a painting, but is a window. This is how we can describe the COR 70 Hidden Sash which, like the 80 mm version, has a sightline of only 66 mm and allows the incorporation of the ARCH INVISIBLE handle, concealed hinges and the drainage solution. Any element that breaks the visual harmony of the ensemble is discarded.

FEATURES

| | | |
|---------------------|--|-------------------------------------|
| Transmittance | | $U_w \geq 1.0$ (W/m ² K) |
| Acoustic insulation | | Rw up to 46 dB |
| Air permeability | | Class 4 |
| Water tightness | | Class E1650 |
| Wind resistance | | Class C5 |
| Security test | | Passed |

Reference test 1.23 x 1.48 m / 1 sash
 Security test: Reference test 1.100 x 2.400 m / 1
 sash CSTB Laboratory DTA Certification

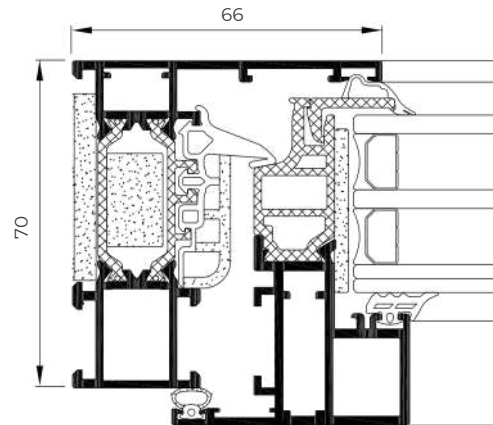

Sightlines

Frame 70 mm, Sash 70 mm

Polyamide Strip Length

35 mm

Profile Thickness

Window 1,9 mm

Glazing

Max. 40 mm, Min. 26 mm

Maximum Sash Dimensions

Standard solution:

Width (L) 1300 mm, Height (H) 2400 mm

HD Hardware (Side Hung):

Width (L) 1200 mm, Height (H) 3500 mm

Maximum Sash Weight

160 kg

Consult maximum weight and dimensions according to typologies

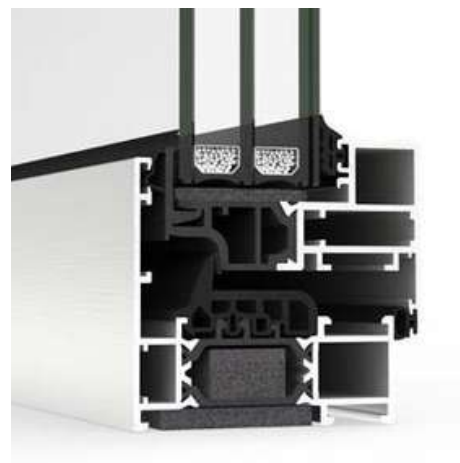

POSSIBILITIES



SECURITY
HARDWARE



CONCEALED
HINGES



CONCEALED
HANDLE



CONCEALED
HANDLE

OPENING POSSIBILITIES



Inward Opening

Side hung
Tilt & turn
Tilt only



CONCEALED DRAINAGE SOLUTION

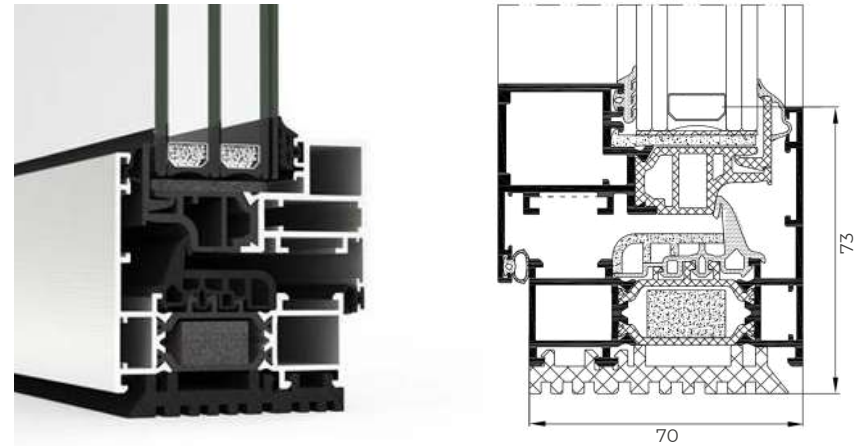

Minimizes the aesthetic impact of the window components.

Compatible with all the 70 mm frame depth systems.

It features a gasket at the bottom of the frame to evacuate the water, replacing the front drainage caps. Facilitates window fabrication, allowing to place the base of the frame on the site itself.

COR 70

OC



Hidden sash system oriented to the French market with monoblock frame that makes installation easier. Using this new frame allows faster fabrication and installation, avoiding overlaps, cills and any other complementary profiles, speeding up assembly and fitting. The fabricator can choose either straight or 45 degree cut.

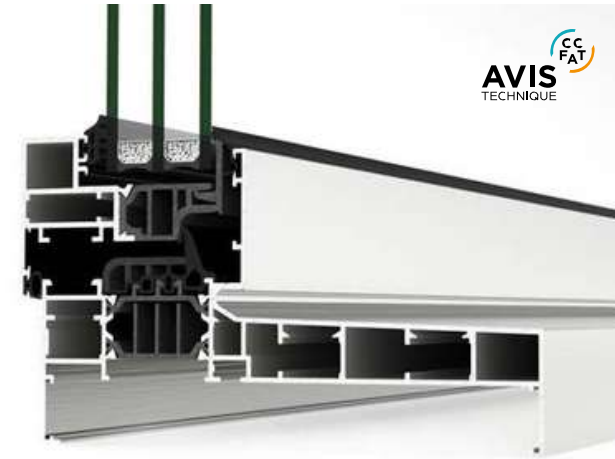

* Mitered frame

FEATURES

| | | |
|---------------------|--|-------------------------------------|
| Transmittance | | $U_w \geq 1.0$ (W/m ² K) |
| Acoustic insulation | | Rw up to 46 dB |
| Air permeability | | Class 4 |
| Water tightness | | Class E1650 |
| Wind resistance | | Class C5 |

Reference test 1.23 x 1.48 m / 1 sash
CSTB Laboratory DTA Certification

POSSIBILITIES



OPENING POSSIBILITIES



Inward Opening
Side hung
Tilt & turn
Tilt only

Sightlines

Frame 70 - 232 mm, Sash 70 mm

Polyamide Strip Length

35 mm

Profile Thickness

Window 1.9 mm

Glazing

Max. 40 mm, Min. 26 mm

Maximum Sash Dimensions

Standard solution:

Width (L) 1300 mm, Height (H) 2400 mm

HD Hardware (Side Hung):

Width (L) 1200 mm, Height (H) 3500 mm

Maximum Sash Weight

160 kg

Consult maximum weight and dimensions according to typologies

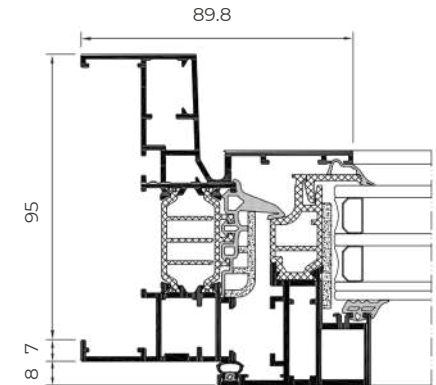

* Mitered frame



COR 70

OC Half - Hidden sash

The half hidden sash version of the COR 70 OC allows to expand the aesthetic possibilities of this series with monoblock frame available at straight or 45 degree cut.



FEATURES

| | | |
|---------------------|--|-------------------------------------|
| Transmittance | | $U_w \geq 1.0$ (W/m ² K) |
| Acoustic insulation | | Rw up to 44 dB |
| Air permeability | | Class 4 |
| Water tightness | | Class E1800 |
| Wind resistance | | Class C5 |

Reference test 1.23 x 1.48 m / 2 sashes
CSTB Laboratory DTA Certification

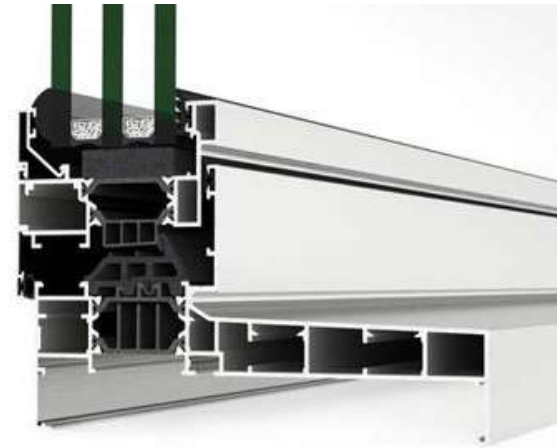

* Mitered frame

POSSIBILITIES



OPENING POSSIBILITIES

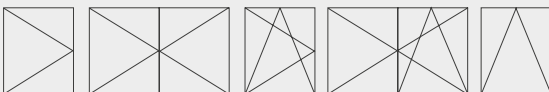

Inward Opening

Side hung
Tilt & turn
Tilt only

Sightlines

Frame 70 - 232 mm, Sash 78 mm

Polyamide Strip Length

32-35

Profile Thickness

Window 1.5 mm

Glazing

Max. 55 mm, Min. 15 mm

Maximum Sash Dimensions

Width (L) 1000 mm, Height (H) 1700 mm

Maximum Sash Weight

160 kg

Consult maximum weight and dimensions according to typologies

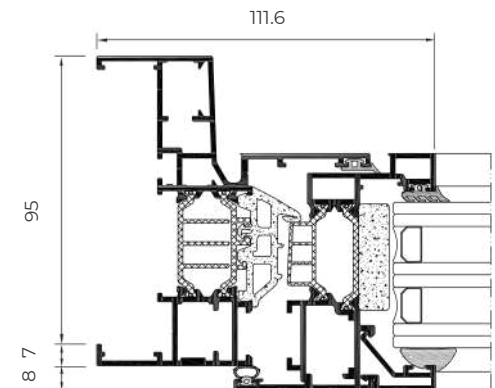

* Mitered frame

aesthetic possibilities



COR 70 OC
Straight cut frame



COR 70 OC
Perimetral frame



COR 70 OC Half - Hidden sash
Straight cut frame



COR 70 OC Half - Hidden sash
Perimetral frame

COR 70 OC



Inspired by classic line designs, the new Alu-Steel system allows to combine aluminium outstanding performances values with a steel-alike appearance. With a sightline of only 72.5 mm, Alu-Steel is the perfect solution for new buildings and refurbishments, offering two different versions, classic or modern.

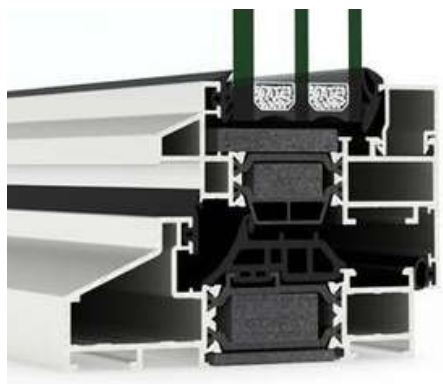

*Classic version



*Modern version

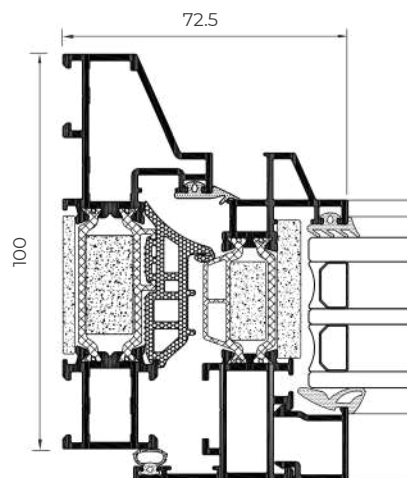

*Classic version

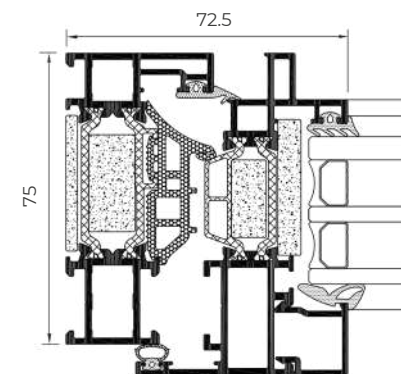

*Modern version

POSSIBILITIES



SECURITY HARDWARE



CONCEALED HINGES



CONCEALED HANDLE



ACCESSIBILITY

OPENING POSSIBILITIES

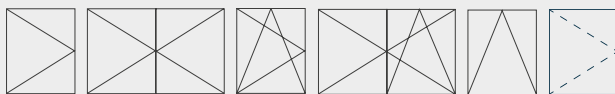

Inward Opening

Side hung
Tilt & turn
Tilt only

Outward Opening

Side hung

FEATURES

| | | |
|---------------------|--|---|
| Transmittance | | $U_w \geq 0.83 \text{ (W/m}^2\text{K)}$ |
| Acoustic insulation | | R_w up to 45 dB |
| Air permeability | | Class 4 |
| Water tightness | | Class E1200 |
| Wind resistance | | Class C5 |

Reference test 1.23 x 1.48 m / 2 sashes

ALU-STEEL



Sightlines

Modern frame 75 mm

Classic frame 100 mm

Sash 83 mm

Polyamide Strip Length

32-39 mm

Profile Thickness

Window 1.5 mm

Glazing

Max. 54 mm, Min. 20 mm

Maximum Sash Dimensions

Width (L) 1500 mm, Height (H) 2600 mm

Maximum Sash Weight

160 kg

Consult maximum weight and dimensions according to typologies

Hinged system with 60 mm of frame depth, featuring 24 mm polyamide strips, which provides a notable thermal and acoustic comfort, achieving a noise reduction of up to 48 dB.

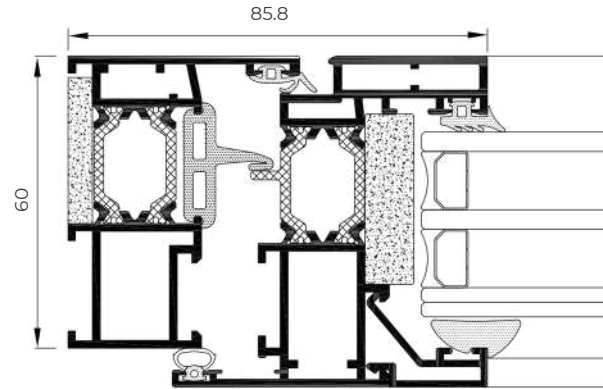

Sightlines

Frame 60 mm, Sash 68 mm

Polyamide Strip Length

24 mm

Profile Thickness

Window 1.6 mm

Door 1.6 mm

Glazing

Max. 46 mm, Min. 5 mm

Maximum Sash Dimensions

Width (L) 1500 mm, Height (H) 2600 mm

Maximum Sash Weight

160 kg

Consult maximum weight and dimensions according to typologies.

Aesthetic possibilities:

Sash: Straight or curved

Glazing Bead: Straight or curved

POSSIBILITIES



SECURITY HARDWARE



CONCEALED HINGES



ACCESSIBILITY

OPENING POSSIBILITIES

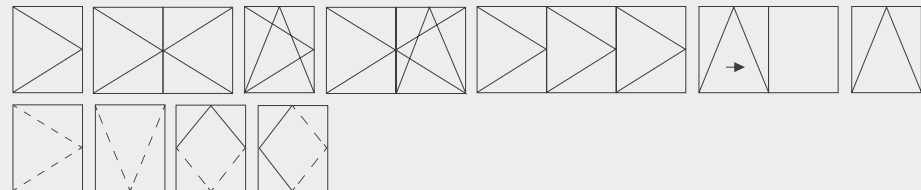

Inward Opening

Side hung
Tilt & turn Bi-fold
Tilt & parallel
Bottom hung

Outward Opening

Side hung
Top hung
Pivoting on horizontal or vertical axis.

FEATURES

Transmittance



$U_w \geq 1.0$ (W/m²K)

Acoustic insulation



R_w up to 48 dB

Air permeability



Class 4

Water tightness



Class E1350

Wind resistance









Class C5



COR 60

Hinged system with groove 16 destined for the industrial production of windows, doors and balconies. In order to reduce the manufacturing period, this new series offers the possibility of using pre-assembled gaskets, assembling cleats and a central floating mullion with a two piece hidden sash, which allows the glazing of double-sash windows on site. COR 70 Evolution is presented in a version of hidden or half-hidden sash with monoblock frames, in straight cut or perimetral, aiming at facilitating the on-site installation.

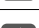
FEATURES

| | | |
|----------------------------------|---|-------------------------------------|
| Transmittance Hidden Sash |  | $U_w \geq 1,0$ (W/m ² K) |
| Transmitancia Half Hidden Sash |  | $U_w \geq 0,9$ |
| Acoustic insulation |  | (W/m ² K) R_w up |
| Air permeability |  | to 43 dB Class 4 |
| Water tightness Hidden Sash |  | Class E1200 |
| Water tightness Half Hidden Sash |  | Class E1500 |
| Wind resistance |  | Class C5 |

Reference test 1.23 x 1.48 m / 2 sashes

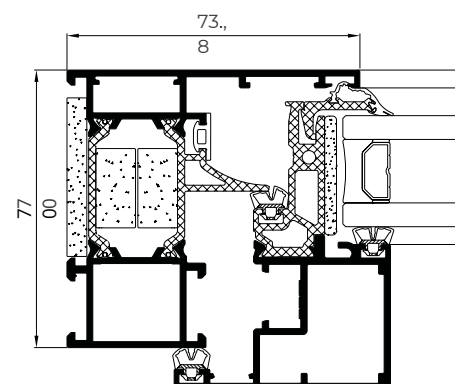

Hidden Sash

Sightlines

Frame 70 - 232 mm

Sash 72,5 - 80,5 mm

Glazing

36 mm

Maximum Sash Dimensions

Width (L) 1300 mm

Height (H) 2400 mm

Maximum Sash Weight

150 kg

Consult maximum weight and dimensions according to typologies

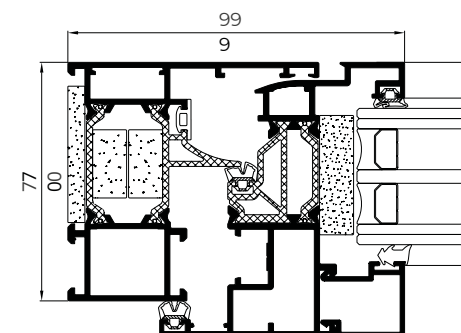

Half Hidden Sash

Sightlines

Frame 70 - 232 mm

Sash 80,5 - 88,5 mm

Glazing

63 mm

Maximum Sash Dimensions

Width (L) 1500 mm

Height (H) 2600 mm

Maximum Sash Weight

150 kg

Consult maximum weight and dimensions according to typologies

POSSIBILITIES



SECURITY
HARDWARE



CONCEALED
HINGES



CONCEALED
HANDLE

OPENING

POSSIBILITIES



Inward Opening

Side hung
Tilt & turn
Tilt only

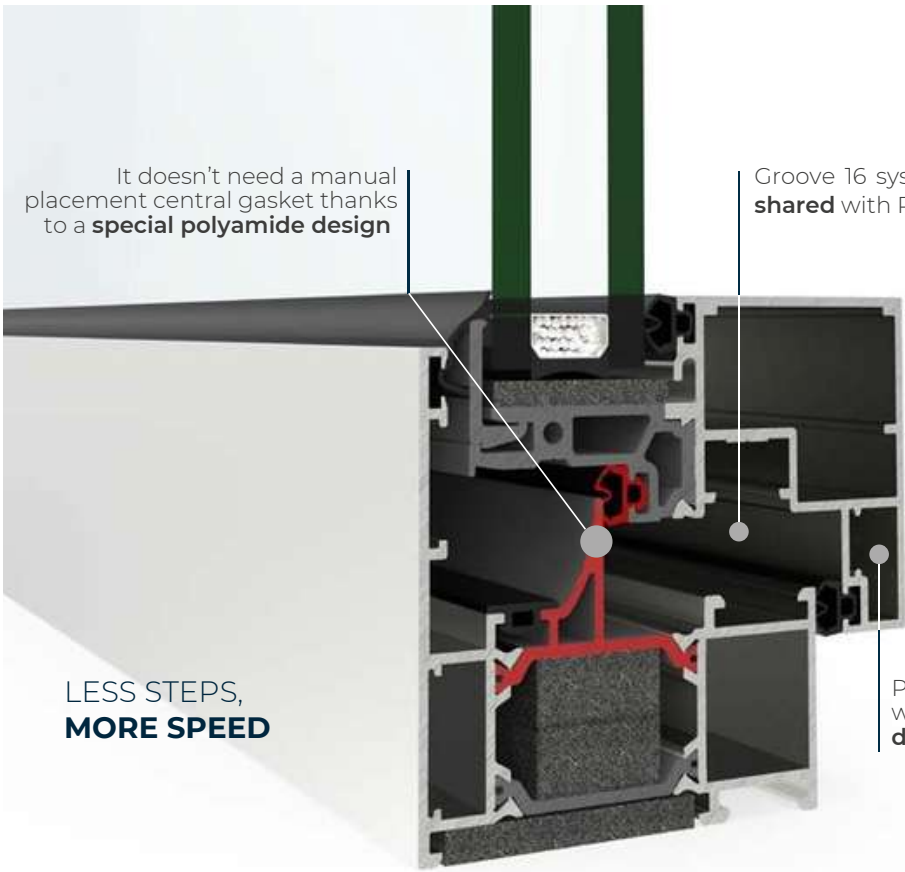

**MANUAL GLAZING
GASKETS AVAILABLE**



Glazing gasket
6.5 mm



Glazing gasket
8.5 mm



Glazing gasket
2.5 mm



Glazing gasket
4.5 mm

**POSSIBILITY OF PROVIDING
PREASSEMBLED GASKETS**

Gaskets available
in black and grey



COR 70

Evolution



aesthetic possibilities



Hidden sash



Half - Hidden sash



Perimeter
Monoblock frame



Straight cut
Monoblock frame

COR 70

Evolution

Covers available in **black** or **white**

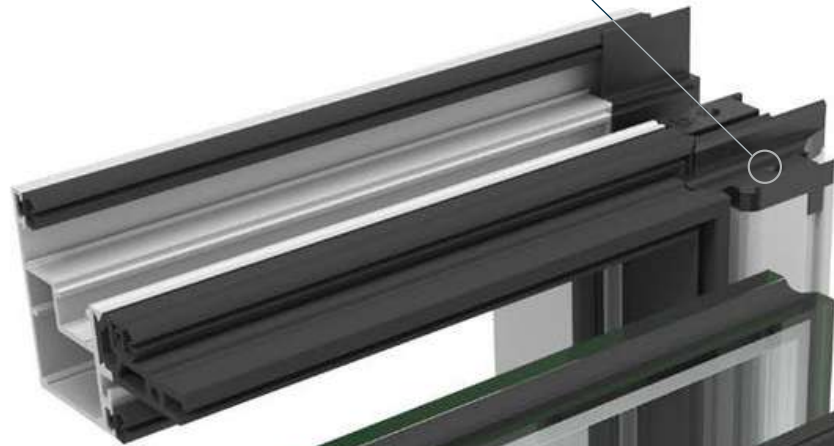

ASSEMBLING CLEATS
In order to speed the assembly up

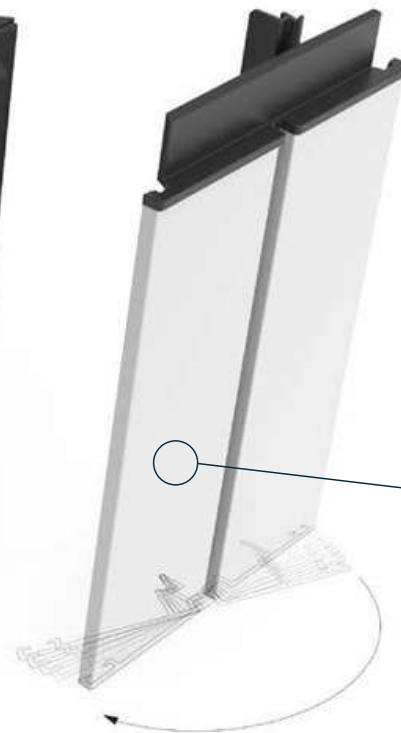
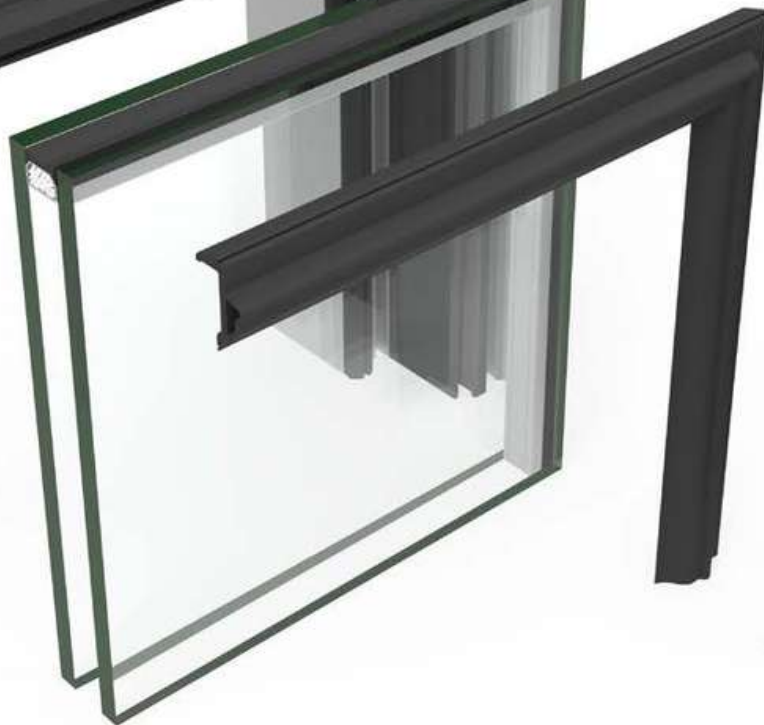

NEW FLOATING MULLION

Floating mullion profile in two parts in order to **facilitate the on-site glazing** without the need to take the profile and hardware apart

This system is especially suitable for buildings located in areas with high acoustic activity. This thermally broken window with double hidden sash of 122 mm, quadruple glazing and 4 gaskets, enables a noise reduction of up to 50 dB.

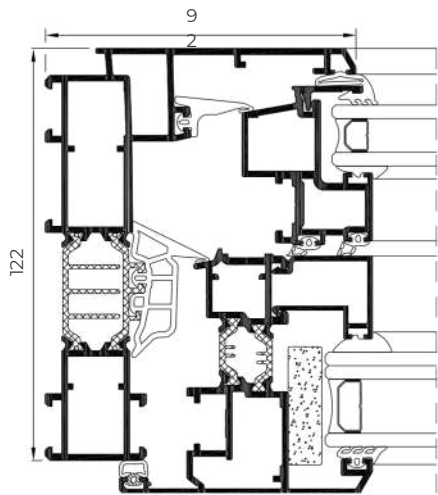

Sightlines

Frame 122 mm, Sash 121 mm

Polyamide Strip Length

Frame 35 mm, Sash 20 mm

Profile Thickness

Window 1.6 mm

Glazing

Internal sash: Max. 38 mm, Min. 13 mm

External sash: Max. 22 mm, Min. 11 mm

Maximum Sash Dimensions

Width (L) 1200 mm, Height (H) 2200 mm

Maximum Sash Weight

150 kg

Consult maximum weight and dimensions according to typologies



Aesthetic possibilities:

Sash: Chamfered / Glazing Bead:

Chamfered

POSSIBILITIES



CONCEALED HINGES

OPENING POSSIBILITIES



Inward opening

Side hung
Tilt & turn

FEATURES

Transmittance $U_w \geq 1.2$ (W/m²K)

Acoustic insulation R_w up to 50 dB

Air permeability Class 4

Water tightness Class E1650

Wind resistance Class C5

Reference test 1.23 x 1.48 m / 1 sash



COR URBAN C16

COR GALICIA

Premium C16



Thermally broken mixed system that combines an external aluminium profile and its excellent performance with the warmth and design that an internal timber profile provides. Any of the finishes amongst the extensive range of CORTIZO powder coating or anodizing finishes may be selected for the surface treatment of the external face. On the other hand, the internal face is available in American oak, sapelly, mellis pine and other timber options available on request, all of them treated with a transparent, satin, dissolvent free ecological varnish.

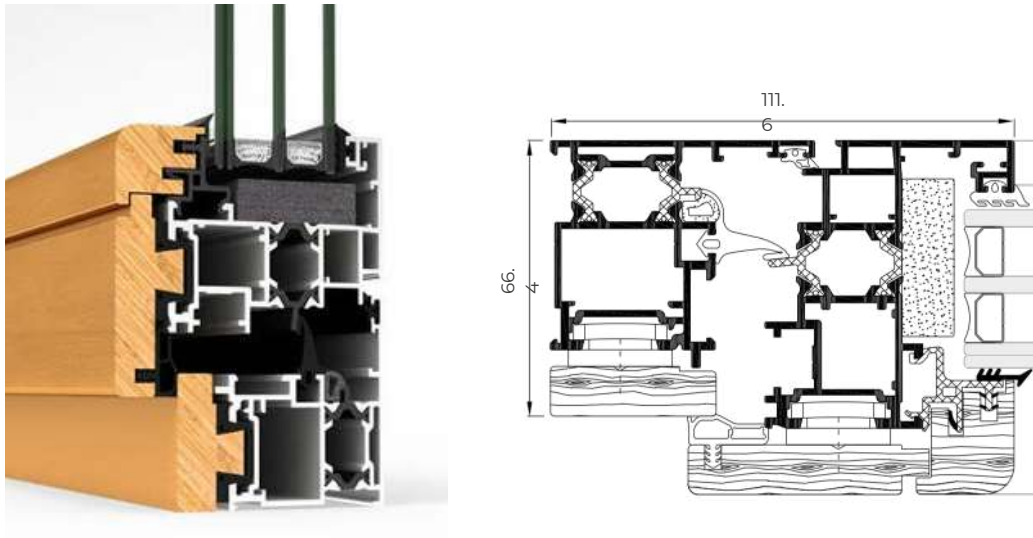

POSSIBILITIES



FEATURES

| | | |
|---------------------|--|-------------------------------------|
| Transmittance | | $U_w \geq 1.1$ (W/m ² K) |
| Acoustic insulation | | Rw up to 40 dB |
| Air permeability | | Class 4 |
| Water tightness | | Class E1050 |
| Wind resistance | | Class C5 |

Reference test 1.23 x 1.48 m / 2 sashes

OPENING POSSIBILITIES



Inward opening

Side hung
Tilt & turn
Tilt & parallel
Bottom hung



CASEMENT



Thermally broken window that allows for both side hung and top hung outward openings. This solution, with a thermal break zone of 32 mm and a transmittance U_w from 1.0 W/m²K, has the British security certification PAS 24, being especially suitable for this market.

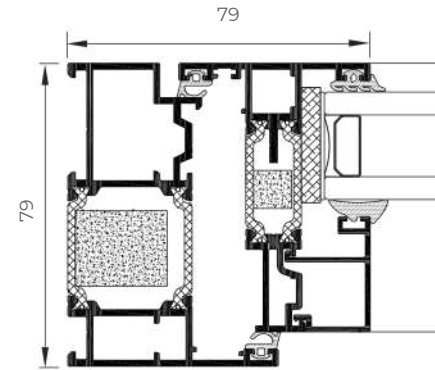

* Flush Version

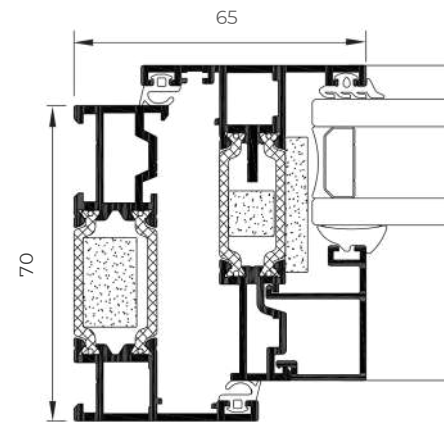

* Standard Version



FEATURES

| | | |
|---------------------|--|-------------------------------------|
| Transmittance | | $U_w \geq 0.9$ (W/m ² K) |
| Acoustic insulation | | Rw up to 45 dB |
| Air permeability | | Class 4 |
| Water tightness | | Class E1200 |
| Wind resistance | | Class CE 2400 |
| Security test | | Passed |

Reference test 1.438 x 1.33 m / 1 sash + 1 fixed light
Security test: Reference test 1.438 x 1.33 m / 1 sash

POSSIBILITIES



SECURITY
HARDWARE



CONCEALED
HINGES

OPENING POSSIBILITIES



Outward Opening

Side hung
Top hung

Sightlines

Frame 70 mm, Sash 70 mm

Polyamide Strip Length

32 mm

Profile Thickness

Window 1.6 mm

Glazing

Max. 44 mm, Min. 23 mm

Maximum Sash Dimensions

Slim Sash (Side Hung):

Width (L) 950 mm, Height (H) 1300 mm

Slim Sash (Top Hung):

Width (L) 1200 mm, Height (H) 1300 mm

Heavy Duty Sash (Side Hung):

Width (L) 750 mm, Height (H) 1750 mm

Heavy Duty Sash (Top Hung):

Width (L) 1800 mm, Height (H) 1800 mm

Maximum Sash Weight

Side Hung Slim Sash: 35 kg

Top Hung Slim Sash: 50 kg

Side Hung Heavy Duty Sash: 42 kg

Top Hung Heavy Duty Sash: 100 kg

Consult maximum weight and dimensions according to typologies



CASEMENT

Millennium Plus 80

DOOR



Flush entrance door system with straight lines, 80 mm of frame depth, and a thermal break zone of 34 mm, particularly suitable for commercial and residential buildings.

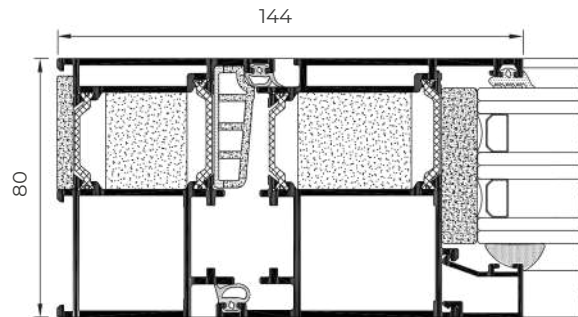

Sightlines

Frame 80 mm, Sash 80 mm

Polyamide Strip Length

34 mm

Profile Thickness

Door 2.0 mm

Glazing

Max. 64 mm, Min. 15 mm

Maximum Sash Dimensions

Door:

Width (L) 1800 mm, Height (H) 3000 mm

Concealed door hinges:

Width (L) 1500 mm, Height (H) 2700 mm

Maximum Sash Weight

220 kg / 120 Kg (concealed hinges)

Consult maximum weight and dimensions according to typologies



FEATURES

| | | |
|--------------------------------|--|-------------------------------------|
| Transmittance | | $U_w \geq 0.8$ (W/m ² K) |
| Acoustic insulation | | Rw up to 40 dB |
| Air permeability | | Class 4 |
| Water tightness | | Class 6A |
| Wind resistance | | Class C4 |
| Resistance to mild impact | | Class 5 (Max.) |
| Repeated openings and closings | | 1,000,000 Cycles |
| Burglar resistance | | Grade RC2 |

Wind resistance: Reference test 1.20 x 2.30 m / 1 sash
 Resistance to mild impact: EN 13049. Test on door reference 1.80 x 2.20 m / 2 sashes. Laminated glass 3+3
 Resistance to repeated openings and closings: EN 1191. Test on door reference 2.10 x 2.20 m / 1 sash
 Burglar test NEN 5096: 2012+AI: 2015 in EN 1627:201

POSSIBILITIES



CONCEALED HINGES



ACCESSIBILITY



AUTOMATION

OPENING POSSIBILITIES

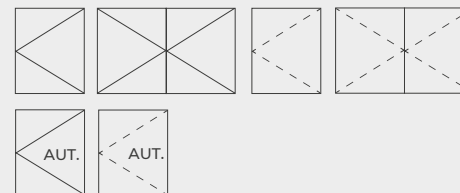

Inward Opening

Side hung

Outward opening

Side hung

Automatic Opening

Inward and outward side hung

Flush entrance pedestrian door system with 70 mm of frame depth that guarantees high thermal and acoustic insulation.



Sightlines

Frame 70 mm, Sash 70 mm

Polyamide Strip Length

24 mm

Profile Thickness

Door 2.0 mm

Glazing

Max. 54 mm, Min. 15 mm

Maximum Sash Dimensions

Door:

Width (L) 1800 mm, Height (H) 3000 mm

Concealed door hinges:

Width (L) 1500 mm, Height (H) 2700 mm

Maximum Sash Weight

220 kg

120 Kg (concealed hinges)

Consult maximum weight and dimensions according to typologies

FEATURES

| | | |
|-------------------------------|--|-------------------------------------|
| Transmittance | | $U_w \geq 0.9$ (W/m ² K) |
| Acoustic insulation | | Rw up to 38 dB |
| Air permeability | | Class 4 |
| Water tightness | | Class 6A |
| Wind resistance | | Class C4 |
| Resistance to mild impact | | Class 5 (Max.) |
| Repeated opening and closings | | 1,000,000 cycles |
| Burglar resistance | | Grade RC2 |

Wind resistance: Reference test 1.20 x 2.30 m / 1 sash
 Resistance to mild impact: EN 13049. Test on door reference 1.80 x 2.20 m / 2 sashes. Laminated glass 3+3
 Security test: EN 5096: 2012+A1: 2015 in EN 1627: 201
 Resistance to repeated openings and closings: EN 1191. Test on door reference 2.1 X 2.2 m / 2 sashes
 Burglar test NEN 5096: 2012+A1: 2015 en EN 1627:201

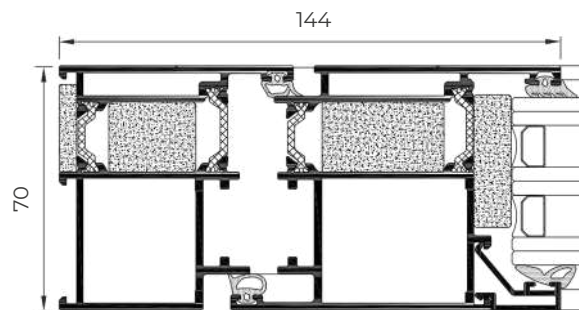

POSSIBILITIES



OPENING POSSIBILITIES

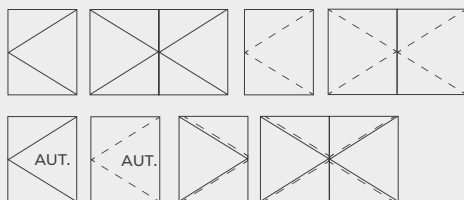

- Inward Opening
- Side hung
- Outward opening
- Side hung
- Automatic Opening
- Outward and inward side hung
- Swing Opening
- Side hung



MILLENNIUM PLUS 80 DOOR



CONCEALED HINGES

The Millennium Plus door system allows **concealed hinges** that reinforce the flush aesthetic of the series



Millennium Plus Pivot

DOOR



The new CORTIZO entrance door system, available in a paneled or glazed version, responds to the latest design trends. Thanks to its axes, it allows large pivot openings, becoming a cutting-edge solution for contemporary architecture. Safety and excellent thermal and acoustic performance are also protagonists in a system that completes CORTIZO's catalog of minimalist solutions.

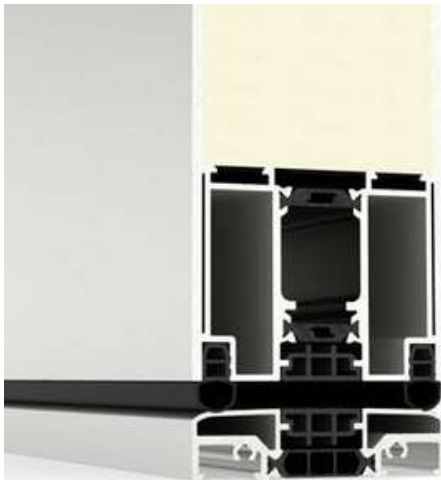

Paneled version

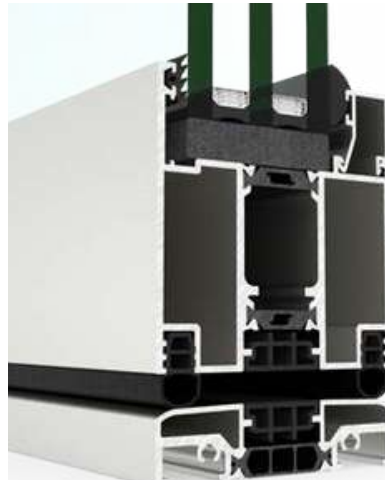

Glazed version

FEATURES

| | | |
|------------------|--|--------------------------------------|
| Transmittance | | $U_w \geq 0,86$ (W/m ² K) |
| Air permeability | | Class 4 |
| Water tightness | | Class 5A |
| Wind resistance | | Class C5 |

Reference test 1.20 x 2.00 m / 1 Sash

POSSIBILITIES

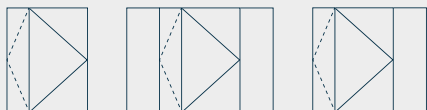

Pivoting

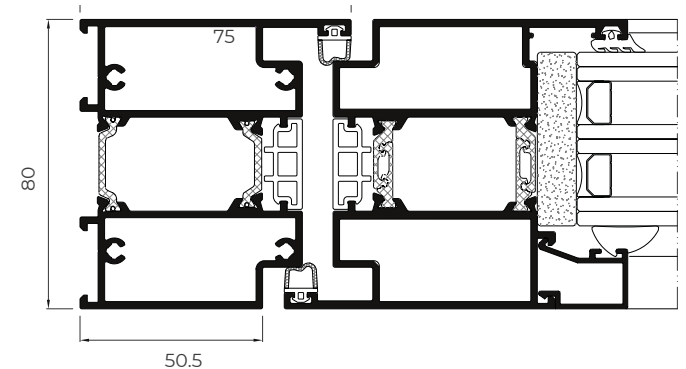
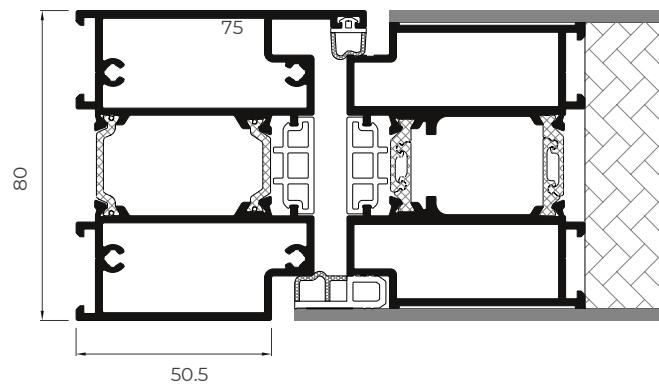

Sightlines

Frame 80 mm, Sash 80 mm

Polyamide Strip Length

24 / 26 mm

Profile Thickness

Door 2,0 mm

Panel

80 mm

Maximum glazing

64 mm

Maximum Sash Dimensions

Width (L) 2100 (1700* + 400) mm

Height (H) 3000 mm

Maximum Sash Weight

250 kg



Consult maximum weight and dimensions according to typologies

* Measured from the pivot axis

Panelled DOOR

Compatible with the Millennium Plus 80 and Millennium Plus 70 series, it incorporates a panel integrated into the sash, which allows a wide range of aesthetic possibilities. In addition, it allows for the installation of an embedded handle with led illumination and a scanner.

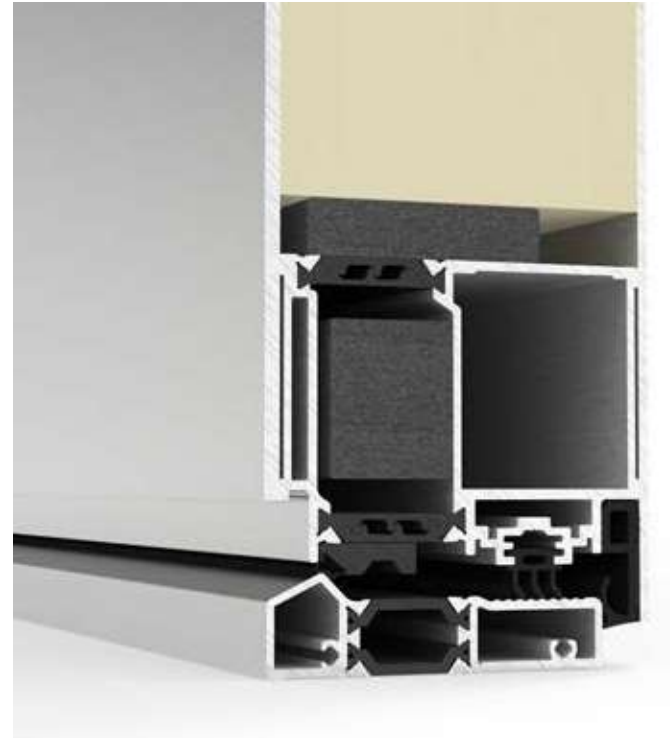
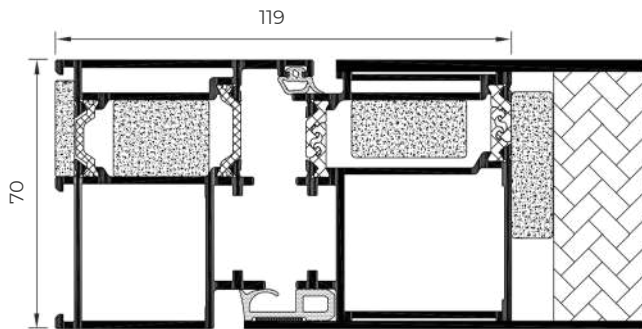

OPENING POSSIBILITIES

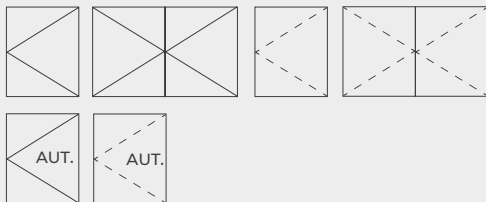

Inward Opening

Side hung
Automatic side hung

Outward Opening

Side hung
Automatic side hung

Wind resistance: Reference test 1.20 x 2.30 m / 1 sash

Resistance to mild impact: Test carried out according to standard EN 13049

Test on door reference 1.80 x 2.20 m / 2 sashes. Laminated glass 3+3

Resistance to repeated openings and closing: Test carried out according to standard EN 1191 Test on door reference 0.935 x 2.10 m / 1 sash

*Compatible with Millennium Plus 70 and 80 doors

Sightlines

Frame 80 / 70 mm, Sash 80 / 70 mm

Polyamide Strip Length

30 / 34 mm (80)

20 / 24 mm (70)

Profile Thickness

Door 2,0 mm

Panel

Max. 80 mm, Min. 33 mm (80)

Max. 70 mm, Min. 23 mm (70)



PANELLED DOOR

Maximum Sash Dimensions

Door:

Width (L) 1800 mm, Height (H) 3000 mm

Concealed door hinges:

Width (L) 1500 mm, Height (H) 2700 mm

Maximum Sash Weight

220 kg

120 Kg (concealed hinges)

Consult maximum weight and dimensions according to typologies

Aluminium fire door system with fire resistance category EI 260 in order to meet safety requirements in the event of fire, allowing the compartmentalisation by building areas and facilitating the evacuation of the users. It offers a fire resistance period of 60 minutes thanks to the use of non-combustible retardant insulation materials in the profile chambers and intumescent gaskets.

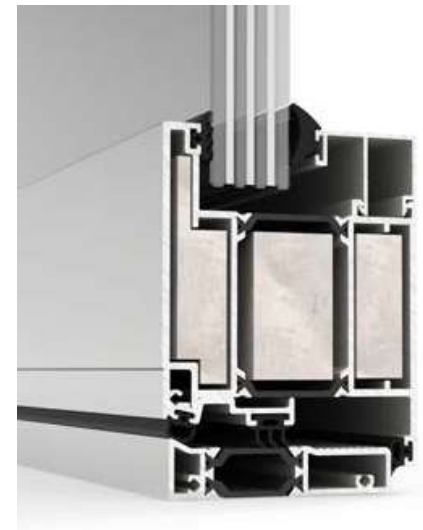
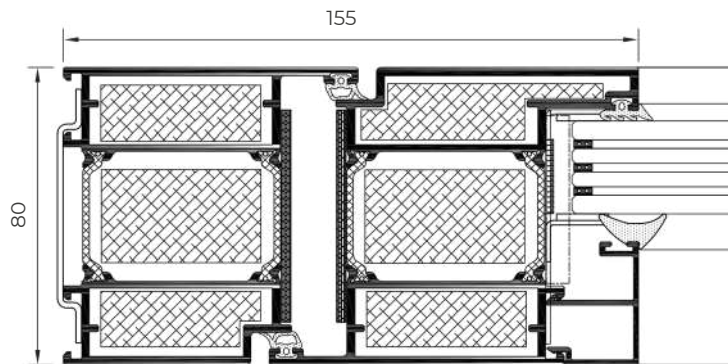

Sightlines

Frame 80 mm, Sash 80 mm

Polyamide Strip Length

35 mm

Profile Thickness

Door 2.2 mm

Glazing

Max. 48 mm, Min. 15 mm

Maximum Sash Dimensions

Width (L) 1450 mm, Height (H) 2600 mm

Maximum Sash Weight

240 kg

Consult maximum weight and dimensions according to typologies

FEATURES

Transmittance  $U_w \geq 1.4$ (W/m²K)

Acoustic insulation  R_w up to 38 dB

Fire resistance and smoke control  Class EI 60-C5

Classification according to standard UNE-EN 13501-2+A1 (C5=200.000 test cycles) Reference test 1.35 x 2.35 m / 1 sash. Glass EI60 single glazed 23 to 25 mm.

OPENING POSSIBILITIES

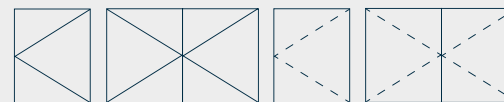

Inward opening

Side hung

Outward Opening

Side hung

Pedestrian door system for commercial and residential buildings that allows the incorporation of double or triple flag hinges of high strength, capable of supporting up to 180 kg. per sash.



Sightlines

Frame 45 mm, Sash 45 mm

Profile Thickness

Door 2.0 mm

Glazing

Max. 30 mm, Min. 3 mm

Maximum Sash Dimensions

Side hung:

Width (L) 1450 mm, Height (H) 3000 mm

Swing:

Width (L) 1100 mm, Height (H) 3000 mm

Maximum Sash Weight

180 kg

Consult maximum weight and dimensions according to typologies

POSSIBILITIES



ACCESSIBILITY

Aesthetic possibilities:

Sash: Straight / Bead: Straight or curved

FEATURES

Transmittance



$U_w \geq 2.3$ (W/m²K)

Acoustic insulation



R_w up to 38 dB

Resistance to mild impact



Class 5 (Max.)

Test carried out according to standard UNE-EN 13059
Reference test 1.80 x 2.20 m / 2 sashes. Laminated glass 3+3

OPENING POSSIBILITIES

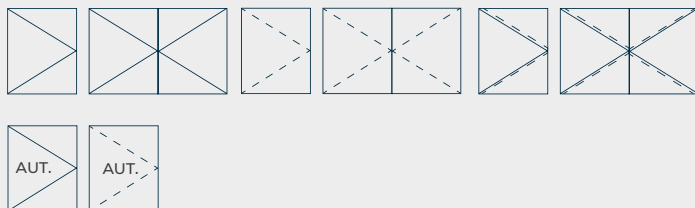

Inward opening

- Side hung
- Automatic side hung

Outward Opening

- Side hung
- Automatic side hung

Swing Opening

- Side hung 1 and 2 sashes

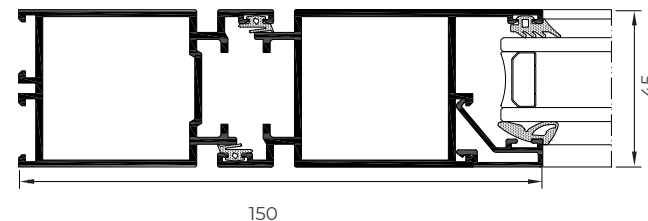



MILLENNIUM SLIDING AUTOMATIC DOOR

Millennium Sliding Automatic

DOOR



Door system with sliding sashes and automatic opening, designed to solve high traffic entrances (offices, shopping centres, hospitals...) since it guarantees fluidity of user's traffic and safety in emergency situations.

POSSIBILITIES



AUTOMATION



ACCESSIBILITY



Sightlines

Frame 45 mm

Sash 45 mm (EC-drive engine)

Sash 25 mm (Slimdrive engine)

Profile Thickness

Door 2.0 mm

Glazing

Max. 30 mm, Min. 3 mm

Maximum Sash Dimensions

Width (L) 2000 mm, Height (H) 3000 mm

Maximum Sash Weight

120 Kg

Consult maximum weight and dimensions according to typologies

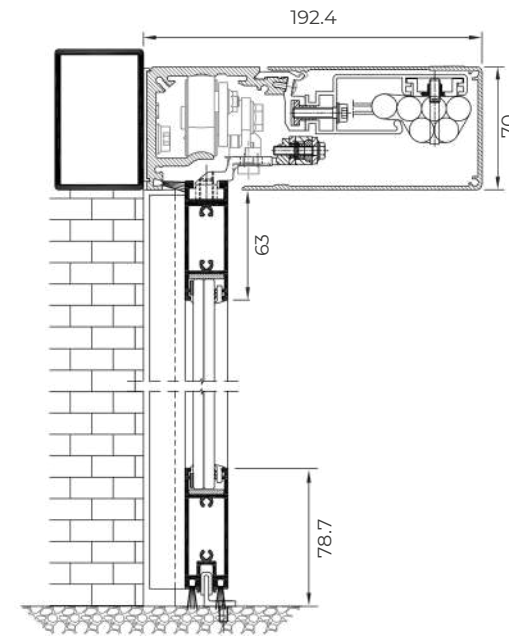

OPENING POSSIBILITIES



Automatic Opening

Sliding 1 sash and 1 fixed light

Sliding 2 sashes and 2 fixed lights

Monumental Bi-fold

DOOR



The new Bi-Fold Monumental door hits the market in order to complete the CORTIZO catalogue of XL systems. Thanks to its large dimensions, we will be able to manufacture sashes up to 5 m high and 1.2 m wide. In addition, the Monumental Bi-fold has proved its great performance against the most extreme meteorological phenomena, and has successfully overcome the tests ASTM E1886-19 and ASTM E1996-17 against hurricanes and structural impacts.

FEATURES

| | | |
|---------------------|--|-------------------------------------|
| Transmittance | | $U_w \geq 1.1$ (W/m ² K) |
| Air permeability | | Passed |
| Water tightness | | DP 60 |
| Wind resistance | | DP 40 |
| Structural Overload | | DP 40 |
| Hurricane impact | | Passed |

Air permeability test at a 75 Pa (ASTM E283-04 (2012))

Water-tightness test (ASTM E547-00 (2016))

Wind resistance test – uniform load deflection at design pressure (ASTM E330-14)

Uniform load structural overload test (OL) at 1.5 design pressure (ASTM E330-14)

Hurricanes impact and structural cycling test: Large missile (missile D) per wind zone 3 and air pressure cycling at DP40 positive / negative (ASTM E1886-19 and ASTM E1996-17) Reference test 3.66 x 3.71 m, 3 sashes

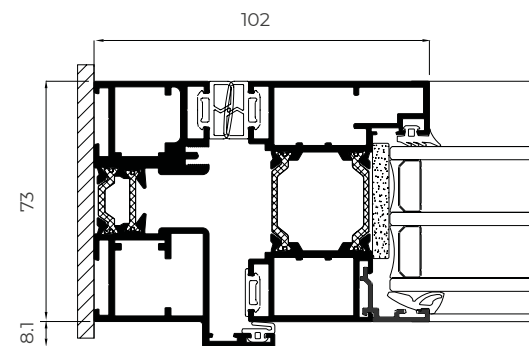
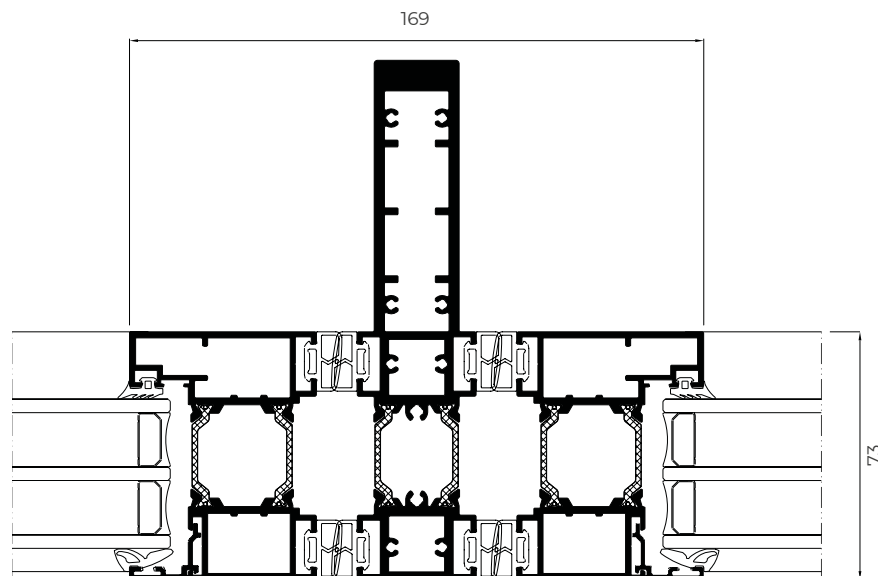

Sightlines

Frame 73 mm, Sash 73 mm

Profile Thickness

Door 1.8 mm

Glazing

Max. 45 mm, Min. 25 mm

Maximum Sash Dimensions

Width (L) 1200 mm, Height (H) 5000 mm

Maximum Sash Weight

220 kg

Consult maximum weight and dimensions according to typologies

OPENING POSSIBILITIES

From 1 to 14 sashes



POSSIBILITIES



SECURITY
HARDWARE



BI - FOLD

Bi-fold Plus

DOOR



Separate environments and unify spaces with this bi-fold door system with an 80 mm deep frame. This evolution of the Bi-fold series offers an excellent thermal and acoustic performance, thanks to its 45 mm thermal break and a glazing capacity up to 52 mm. Besides, it presents a slim central section of 110 mm which allows the maximisation of the glazed surface, filling the interior spaces with natural light.

| FEATURES | | |
|--------------------------------|--|--|
| Transmittance | | $U_w \geq 0.8$ (W/m ² K) |
| Air permeability | | Class 4 |
| Water tightness | | Class E750 |
| Wind resistance | | Class C3 |
| Repeated openings and closings | | 50,000 cycles (Main swing door) 25,000 cycles (Even sashes) |
| Security test | | Passed |

Reference test 3.73 x 2.50 m, 3 sashes
 Security test: 3 sashes reference test. Configuration 321 2.70 x 2.50 m
 Resistance to repeated openings and closings: EN 1191, 3 sashes reference test.
 Configuration 321 3.73 x 2.50 m

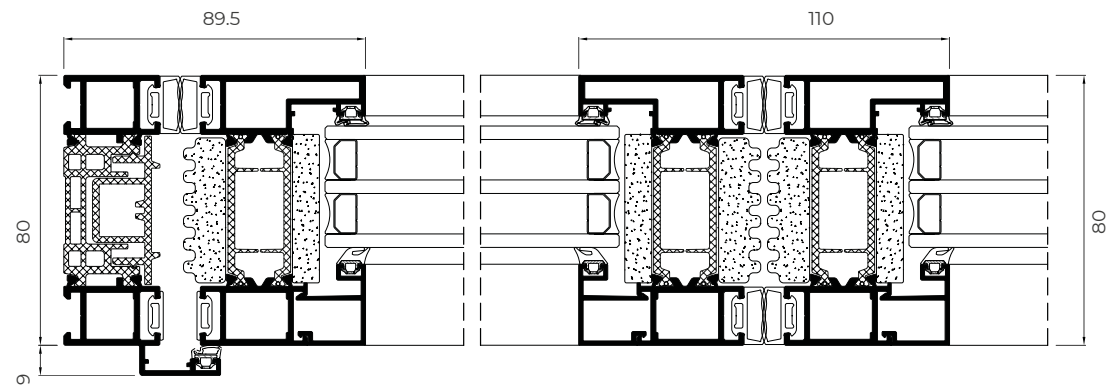

Sightlines

Frame 80 mm, Sash 80 mm

Polyamide Strip Length

Frame 45 mm

Sash 45 mm

Profile Thickness

Door 1.8 mm

Glazing

Max. 48 mm, Min. 25 mm

Maximum Sash Dimensions

Width (L) 1200 mm, Height (H) 3000 mm

Maximum Sash Weight

120 kg

Consult maximum weight and dimensions according to typologies



OPENING POSSIBILITIES



Inward

Up to 14 sashes

Outward

Up to 14 sashes
90° corner sash without mullion

POSSIBILITIES



SECURITY
HARDWARE



ACCESSIBILITY

Bi-fold

DOOR

Bi-fold door system with 73 mm of frame depth and optimal thermal and acoustic performances, ideal for moderate climates.

FEATURES

| | | |
|------------------|---|-------------------------------------|
| Transmittance | | $U_w \geq 1.1$ (W/m ² K) |
| Air permeability | | Class 4 |
| Water tightness | | Class 9A |
| Wind resistance | | Class A3 |
| Security test | PAS24 <input checked="" type="checkbox"/> | Passed |

Wind resistance: reference test 2.700 x 2.530 m / 3 sashes
Security test: Configuration 330. 2701 x 2517 mm / 3 sashes

OPENING POSSIBILITIES

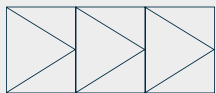

Inward
From 1 to 14 sashes

Outward

From 1 to 14 sashes
Possibility of corner sash at 90° without mullion

POSSIBILITIES



SECURITY
HARDWARE



ACCESSIBILITY

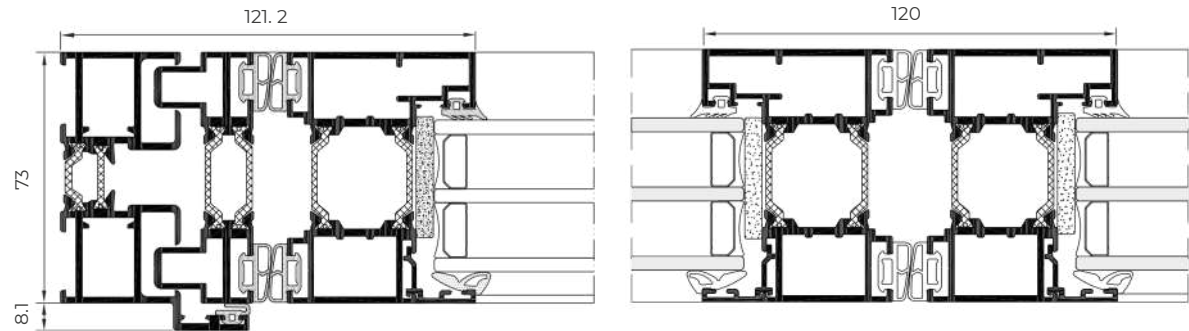

Sightlines

Frame 73 mm, Sash 73 mm

Polyamide Strip Length

Frame 20 mm

Sash 30 mm

Profile Thickness

Door 1.8 mm

Glazing

Max. 45 mm, Min. 25 mm

Maximum Sash Dimensions

Width (L) 1200 mm, Height (H) 3000 mm

Maximum Sash Weight

120 kg

Consult maximum weight and dimensions according to typologies



COR VISION

Plus



The greatness of minimalism is reflected in this sliding system of large dimensions with sashes of up to 4 meters, interlock sightline of only 25 mm and frames embedded in the perimeter, allowing for a glazed surface of up to 94%. It has a maximum glazing capacity of 56 mm, offering excellent thermal and acoustic performances. Available with manual (up to 400 kg) or motorized (up to 700 kg) opening system. Additionally, accessibility is favoured by the possibility of hiding the rail and even integrating it fully into the floor.

Sightlines

Frame 180 mm / 278 mm 3 rails

Sash 69 mm

Polyamide Strip Length

Frame 40 mm

Sash 18 / 32 mm

Profile Thickness

Door 2.0 mm

Glazing

Max. 56 mm, Min. 36 mm

Maximum Sash Dimensions

Width (L) 4000 mm, Height (H) 4000 mm

*Glazed surface 14 m²

Maximum Sash Weight

400 kg Manual

700 Kg Motorized

Consult maximum weight and dimensions according to typologies



FEATURES

| | | |
|---------------------|--|-------------------------------------|
| Transmittance | | $U_w \geq 0.9$ (W/m ² K) |
| Acoustic insulation | | Rw up to 43 dB |
| Air permeability | | Class 4 |
| Water tightness | | Class 7A* / 9A** |
| Wind resistance | | Class C3* / C4** |

Wind resistance:

* Reference test balcony 4.00 x 3.00 m / 2 sashes

**Reference test balcony 4.00 x 3.00 m / 1 sash + 1 fixed light

OPENING POSSIBILITIES

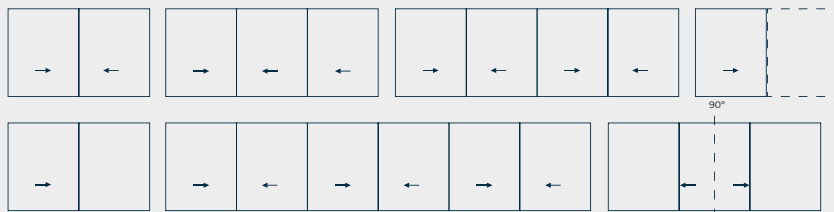

Sliding

Possibility of 1, 2, 3 or 4 rails

Possibility of interior and exterior corner sash at 90° without mullion

Pocket possibility

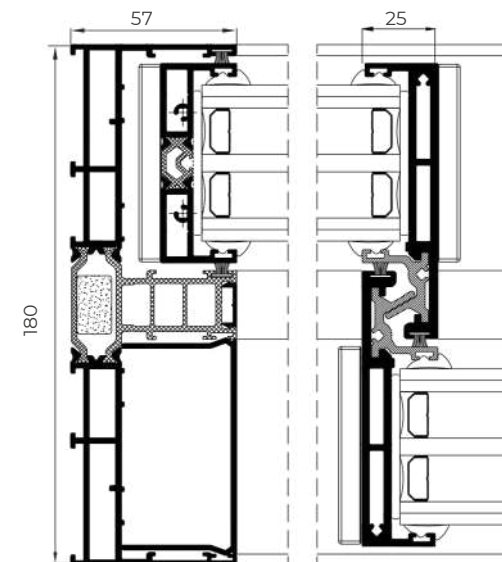

COR VISION PLUS



DRAINAGE SOLUTION

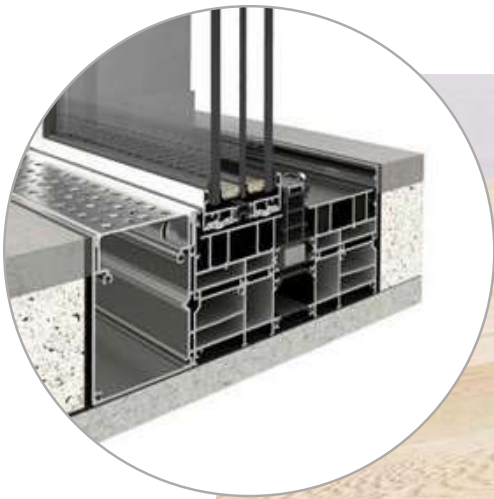

HIDDEN TRACK SOLUTION

Possibility of **embedding the bottom profile and integrate it within the floor finish** (pallet, pavement, ceramic...), achieving a transition without any obstacle between the interior and exterior of the room.



SECURITY HARDWARE

FLUSH SECURITY HARDWARE

MAXIMUM SECURITY

Locking system with internal and external key. Embedding of the hardware into the profile with the same minimalist aesthetic. Possibility of powder coating in any color to provide uniformity to the ensemble.

POSSIBILITIES



AUTOMATION



ACCESSIBILITY



HIDDEN SASH

Allows the concealment of the sashes in the lateral corners

INTERLOCK PROFILE

Only 25 mm

Option of
INTERLOCK HANDLE

MAX. GLAZING

Up to 56 mm

LARGE DIMENSIONS

Up to 4000 mm of height or width / sash

UP TO 700 KG /
Motorized **UP TO 400 KG**
/ Manual

Thermally broken minimalist sliding system that provides maximum luminosity with a minimal aluminium interlock profile. It has an elegant design only 20 mm sightline and offers the possibility of an inlaid closing system and of hiding the frame along the perimeter.

Possibility of locking system in the interlock, thus allowing the concealment of the sashes in the frame from a frontal view.

Possibility of embedded locking system which facilitates the sashes crossing.

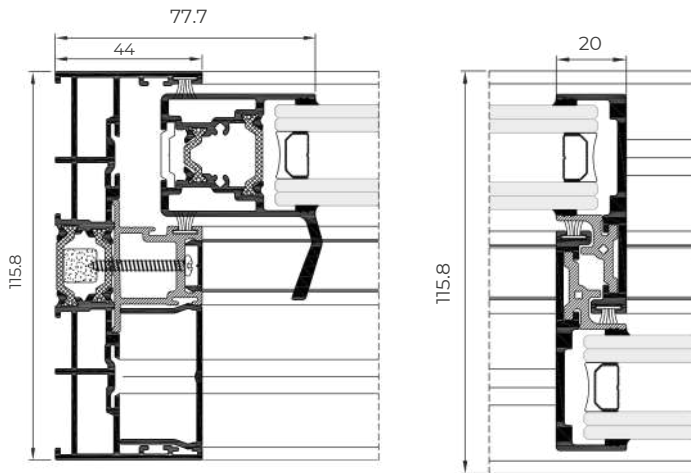

Sightlines

Frame 116 mm / 182 mm 3 rails

Sash 37 mm

Polyamide Strip Length

16 / 24 mm

Profile Thickness

Door 1.7 mm

Glazing

Max. 30 mm, Min. 26 mm

Maximum Sash Dimensions

Width (L) 2500 mm, Height (H) 3000 mm

Maximum Sash Weight

320 Kg

Consult maximum weight and dimensions according to typologies

FEATURES

Transmittance $U_w \geq 1.3$ (W/m²K)

Acoustic insulation R_w up to 41 dB

Air permeability Class 4

Water tightness Class 7A

Wind resistance Class C5

POSSIBILITIES



ACCESSIBILITY

OPENING POSSIBILITIES

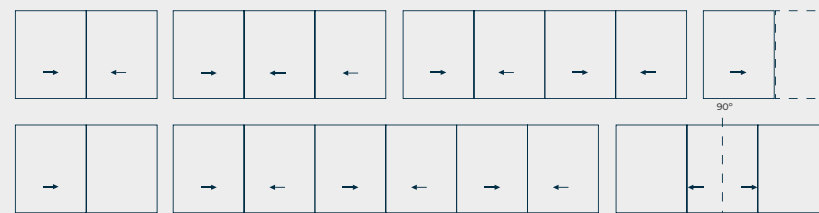

Sliding
Possibility of 1, 2 or 3 rails
Possibility of interior and exterior corner at 90° without mullion
Pocket possibility



4600 HI

Lift & Slide



Ideal solution to close large spans, offering excellent thermal (U_w from 0.9 W/m^2K) and acoustic (R_w up to 43 dB) performance along with a modern design with straight aesthetics in the sashes and glazing beads. It includes a hardware system that slightly elevates the sash when the handle is operated, facilitating its movement in the opening and closing motions, even in the case of sashes with large dimensions and weight. Possibility of a reduced interlock sightline of 50 mm.

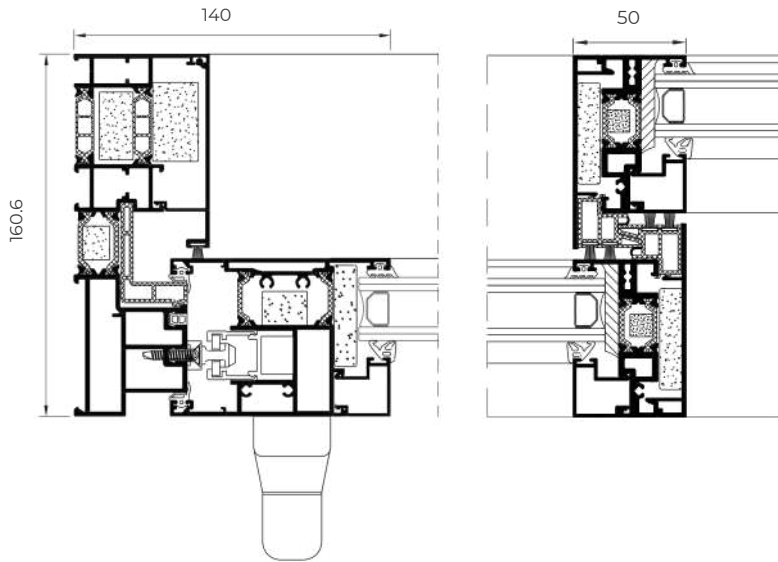

FEATURES

| | | |
|---------------------|--|-----------------------------|
| Transmittance | | $U_w \geq 0.9$ (W/m^2K) |
| Acoustic insulation | | R_w up to 43 dB |
| Air permeability | | Class 4 |
| Water tightness | | Class 9A |
| Wind resistance | | Class C5 |

POSSIBILITIES



Sightlines

Frame 160.6 mm / 251 mm 3 rails,
Sash 70 mm

Polyamide Strip Length

Frame 35 mm
Sash 24 mm

Profile Thickness

Door 2.0 mm

Glazing

Max. 55 mm, Min. 15 mm

Maximum Sash Dimensions

Width (L) 3300 mm, Height (H) 3300 mm

Maximum Sash Weight

400 kg

Consult maximum weight and dimensions according to typologies

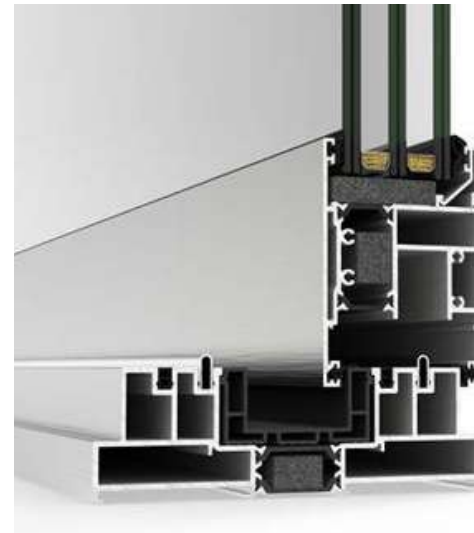

OPENING POSSIBILITIES

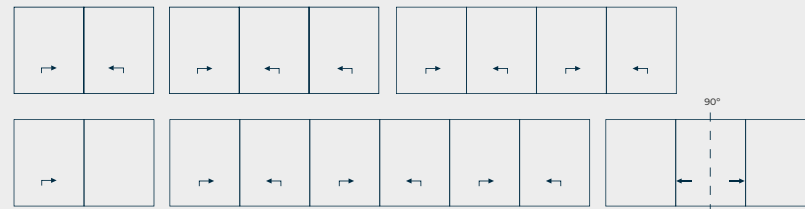

Lift & Slide

1 rail (sash + fixed light), 2 and 3 rails

Possibility of 90° opening without mullion

This sliding system, available both in slide and lift & slide versions, becomes an ideal solution for closing large spans. It presents modern aesthetics in straight lines, a reduced interlock section and large glazed surfaces that ensure bright and comfortable areas, due to its thermal and acoustic performance.



Standard Slide



Lift & Slide

FEATURES

| | | |
|---------------------|--|-------------------------------------|
| Transmittance | | $U_w \geq 1,1$ (W/m ² K) |
| Acoustic insulation | | Rw up to 40 dB |
| Air permeability | | Class 3* / 4** |
| Water tightness | | Class 7A |
| Wind resistance | | Class C5* / C2** |
| Security test | | Passed |

* Reference slide test 1,8 x 2,2 m / 2 sashes

** Reference lift & slide test 4,0 x 2,50 m / 2 sashes

Security test: Reference test 2,40 x 2,40 m / 2 sashes

OPENING POSSIBILITIES



- Sliding
- 1 rail (1 sash + 1 fixed light)
- 2, 3 & 4 rails
- Galandage

POSSIBILITIES



ACCESSIBILITY

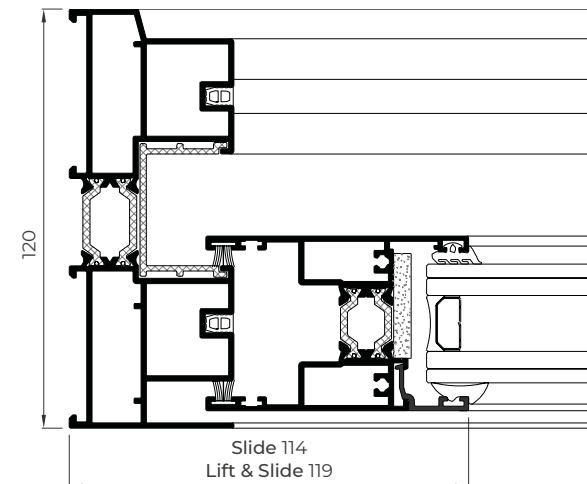



Sightlines

Frame 115 and 120 mm, 185 mm 3 rails
Sash 50 mm

Polyamide Strip Length

20-25 mm

Profile Thickness

Balcony 1.5 mm

Glazing

Max. 36 mm, Min. 26 mm

Maximum Sash Dimensions

Width (L) 2500 mm, Height (H) 3000 mm

Maximum Sash Weight

Slide 280 Kg

Lift & Slide 300 Kg

Consult maximum weight and dimensions according to typologies

4700 SLIDING

4900 HI

Sliding

Standard sliding system with hinged features. Offers great thermal and acoustic performance favoured by a glazing capacity of up to 36 mm and a thermal break zone of 34 mm. It has a interlock section of 35 mm and straight lines, allowing the sashes to cross over thanks to the integrated handle with multilock system.

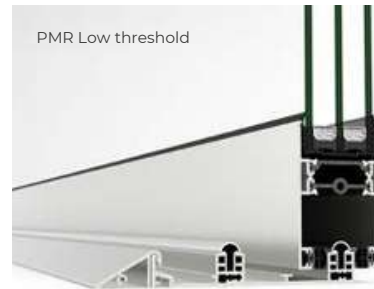

POSSIBILITIES



ACCESSIBILITY

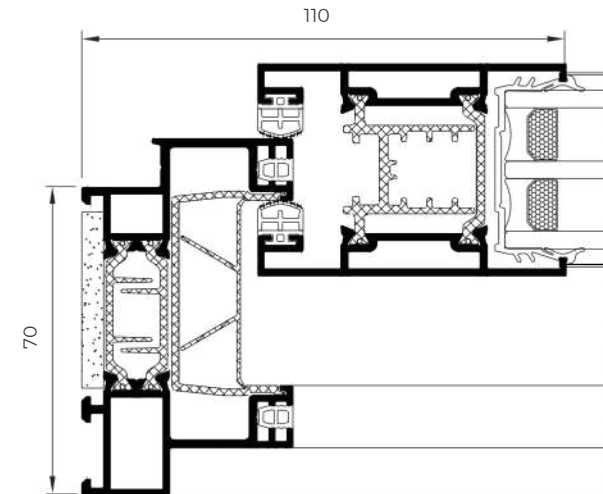

OPENING POSSIBILITIES



Sliding
 1 rail (sash + fixed light)
 2 and 3 rails
 Pocket possibility
 Possibility of 90° opening without mullion

FEATURES

| | | |
|---------------------|--|-------------------------|
| Transmittance | | $U_w \geq 1.2 (W/m^2K)$ |
| Acoustic insulation | | Rw up to 40 dB |
| Air permeability | | Class 4 |
| Water tightness | | Class 7A |
| Wind resistance | | Class C5 |

Reference test 1.80 x 2.20 m / 2 sashes
 CSTB Laboratory DTA Certification

Sightlines
Frame 60, 70, 89, 120, 125, 130 mm
126, 145 mm 3 rails
201 mm 4 rails
Sash 48 mm

Polyamide Strip Length
34 mm

Profile Thickness
Window 1,6 mm

Glazing
Max. 36 mm, Min. 24 mm

Maximum Sash Dimensions
Width (L) 2200 mm
Height (H) 3000 mm

Maximum Sash Weight
240 kg



4900 HI SLIDING

Consult maximum weight and dimensions according to typologies

Standard sliding system with great versatility and straight or curved aesthetics, 45° or 90° sash encounters and various frames according to each configuration. The 45° and 90° sash encounter version allows the total opening of the span with the pocket possibility solution, completely concealing the sashes in the masonry wall's chamber. Furthermore, this version allows the integration of the solar protection Tamiz system on the same frame.

FEATURES

| | | |
|---------------------|--|-------------------------|
| Transmittance | | $U_w \geq 1.5 (W/m^2K)$ |
| Acoustic insulation | | Rw up to 39 dB |
| Air permeability | | Class 3 |
| Water tightness | | Class 7A |
| Wind resistance | | Class C5 |

Reference test 1.20 x 1.20 m / 2 sashes

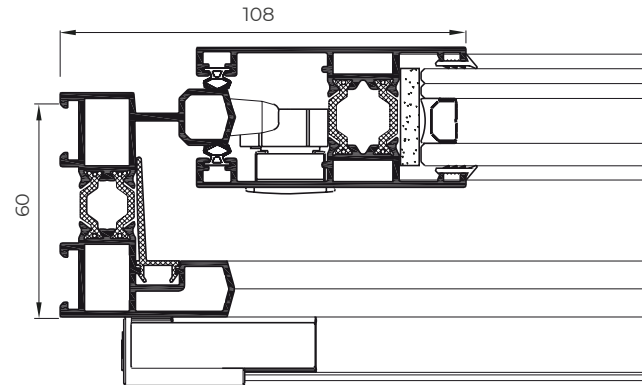

Sightlines

Frame 60 / 65 / 77 / 80 mm
106 / 126 mm 3 rails
Sash 33 / 37 mm

Polyamide Strip Length

From 14.6 - 20 mm

Profile Thickness

Window 1.5 mm

Glazing

Max. 26 mm, Min. 9 mm

Maximum Sash Dimensions

Width (L) 2200 mm
Height (H) 2600 mm

Maximum Sash Weight

100 Kg 45° sash encounter
200 Kg 90° sash encounter

Aesthetic possibilities:

Sash: Straight or curved
Bead: Straight or curved

Consult maximum weight and dimensions according to typologies

OPENING POSSIBILITIES



Sliding
1, 2 and 3 rails
Pocket possibility 1 and 2 rails



4200 SLIDING

BARS

APPLIED BARS

The applied bars are glued to the outer surface of the glass and have the effect of accentuating the chosen pattern and integrating into the overall appearance of the facade.

The glass is divided according to the pattern of the bar on the outside using the Warm Edge or aluminium spacer.



INTERNAL BARS

The integrated bars, used as a decorative element, are placed between the two panes of the double pane glazing package, which allows easy maintenance of the window.

They are both a decorative part of the architectural style for renovations and a tool to satisfy every taste for new construction.



STYLISH HANDLE

The new **Stylish handle** presents a simple design, with more accentuated lines and stylish aesthetics for dressing in style the CORTIZO windows, balconies and doors.



Presenting of the news
DELTA MULTIPOINT PULL handle with fixed opening or left or right. Compatible with aluminum sliding systems (sliding doors 2000, 4200, 4700, 4900).

WINDOW HANDLE



OFFSET HANDLE



HANDLE WITH KEY



Design with slim backplate
Version for external, internal and PVC assembly
Available in window and door version
Quick setting-up
Available in the full powder-coating range

DOOR HANDLE



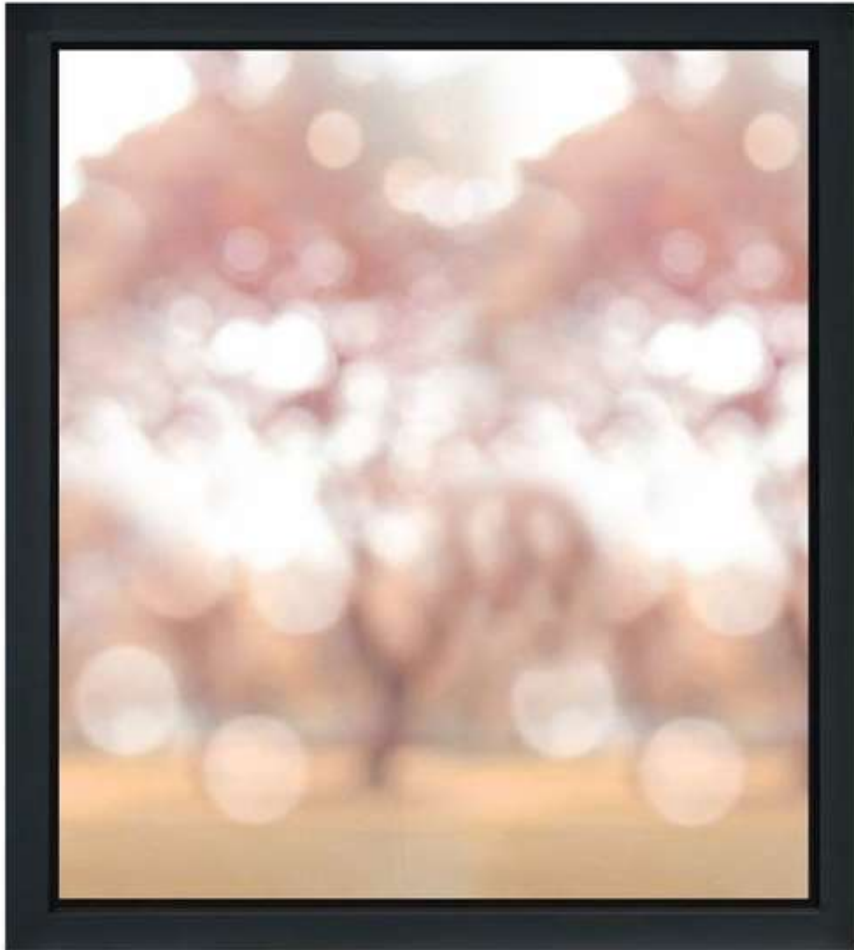

ARCH INVISIBLE HANDLE

Exclusive handle integrated within the sash, imperceptible from the frontal view

Compatible with the COR 80 Hidden Sash and COR 70 Hidden Sash systems
Ergonomics, robustness and easy handling in the opening and closing operations
Ideal for combination with concealed hinges, achieving a totally clean aesthetic
Dimensions 27.5 x 234 mm



MINIMALIST HANDLE

Avant-garde design without escutcheon
Suitable for all Euro-Groove hinged series
and PVC series

Specific transmission box

Possibility of painting in the same colour
as the carpentry

Spindle: 8 mm

Dimensions: 32 x 148 mm



CORTIZO HANDLE

Reduced escutcheon design
Adaptability to transmission box and multilock system
Concealed hardware
Spindle: 7 mm
Dimensions 32 x 148 mm



CORTIZO DOOR HANDLE

Reduced escutcheon design
Opening to the right and to the left versions
Suitable for exterior and interior assembly
Available in door version
Concealed hardware
Spindle: 8 mm
Dimensions 32 x 148 mm



INOX HANDLE

Reduced escutcheon design

Adaptability to transmission box and multilock system Available in door version

Concealed hardware

Spindle: 7 mm

Dimensions: 31 x 135 mm



SIRIUS HANDLE

Curved aesthetics
Design with a reduced escutcheon
Suitable for multipoint lock
Available for windows or doors
Spindle: 7 mm
Dimensions: 32 x 155 mm



CORTIZO CREMONE WITH KEY

Maximum security
3 locking positions: full lock,
tilt only and tilt and turn
Dimensions: 33 x 190 mm



REMOVABLE CORTIZO CREMONE

Easy assembly
Handle clipped on the
escutcheon Possibility of
removing the handle
in any position
Maximum durability
Dimensions: 33 x 173 mm



ART INFINITY PULL HANDLE

Suitable for high traffic and
large dimension doors
Straight or curved design
Dimensions: 450 x 50 mm



LIFT & SLIDE HANDLE

Avant-garde aesthetic
Exclusive to systems
4600 and 4500 Lift & Slide
Versions with or without key
Multiple combinations:
handle / handle
handle / finger pull
Tested to 25,000 cycles
Spindle of 10 mm
Dimensions: 37 x 290 mm



CORTIZO OFFSET HANDLE

Handle specially designed
for sliding systems
Reduced escutcheon
Suitable for exterior and interior
Spindle: 7 mm
Dimensions: 32 x 158 mm



VISION SECURITY LOCK

Key lockable
Integration of the locking
system in the profile with
minimalist aesthetics
Up to 4 locking points
Dimensions: 36 x 260 mm



FLUSH VISION SECURITY LOCK

Key lockable
Lock flush with the profile
Up to 4 locking points
Dimensions: 36 x 260 mm



VISION SECURITY MINI LOCK

Straight aesthetics in line
with the minimalist style
of the system
Dimensions: 26 x 92 mm



VISION CENTRAL LOCK

Suitable for the COR VISION and
COR VISION PLUS systems
Integrated in the interlock profile
It allows to conceal the
lateral sashes
Dimensions: 450 x 50 mm

Color options for Aluminium joinery



Standard colors



Textured colors

Forster Profile Systems in steel and stainless steel



PROFILE SYSTEMS IN STEEL

WITH THERMAL BARRIER



In a world shaped by rapid technological advancements and societal shifts, the demand for innovative building solutions remains ever-present. Forster Profile Systems recognizes this evolving landscape and stands ready to meet the challenges head-on. Their expertise in steel construction allows them to seamlessly integrate functional and visually captivating designs, catering to the dynamic needs of modern society.

At the core of Forster's philosophy lies a commitment to longevity and sustainability. They view building with steel as a means of creating structures that serve not only the present but also future generations. With a keen awareness of environmental concerns and a deep respect for natural resources, Forster Profile Systems approaches every project with a dedication to eco-friendly practices and responsible stewardship.

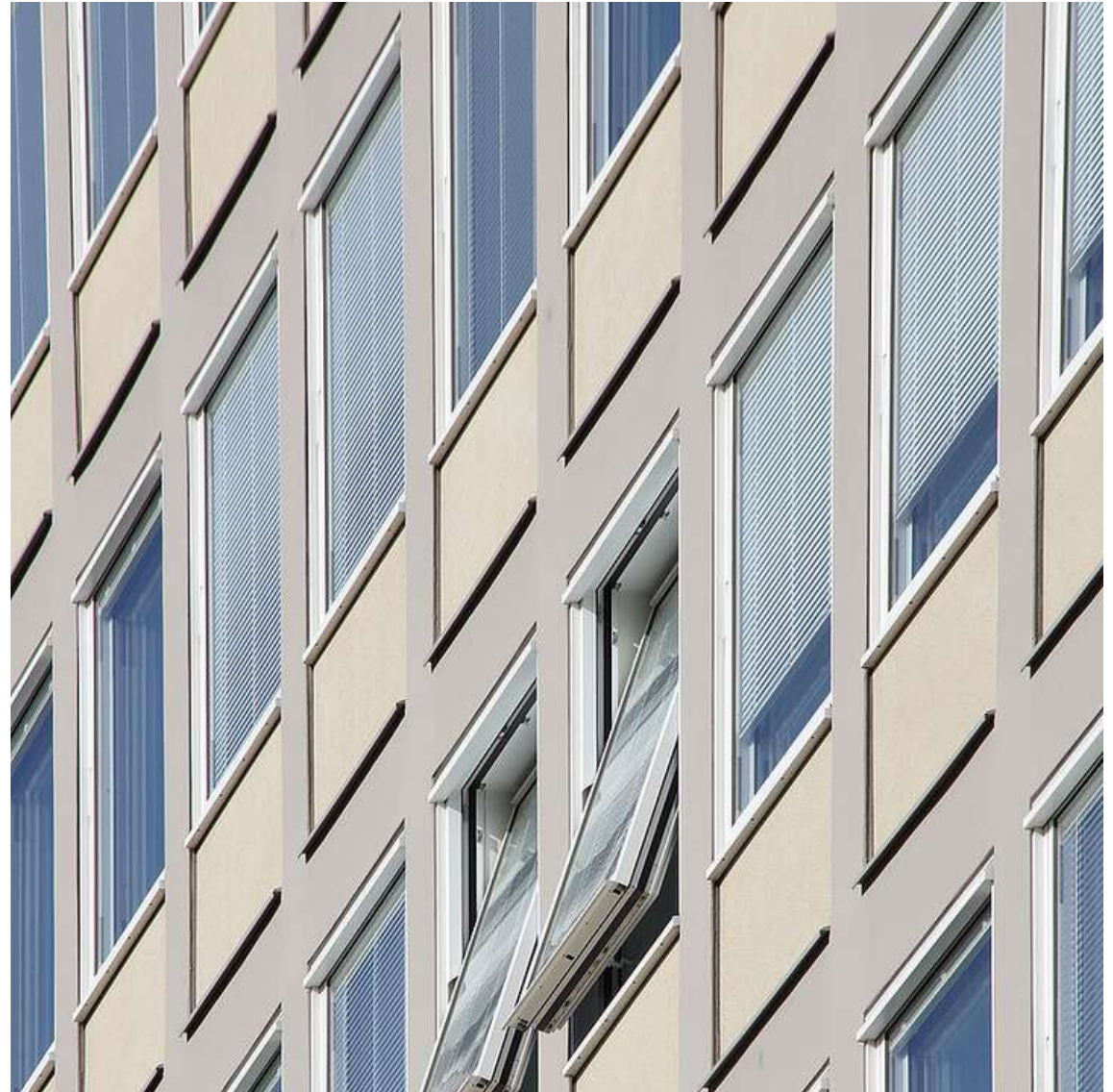

PROFILE SYSTEMS IN STEEL

forster

FORSTER UNICO XS WINDOW

Material variants

Bright steel
Steel zinc magnesium

Face widths

Window sash and overlapping casement from 55 mm
Fixed glazing from 23 mm

Dimensions

Max. leaf width: 1440 mm
Max. leaf height: 2440 mm
Fixed glazing (W×H): unlimited × max. 3000 mm

Fittings

Attached and concealed flush fittings
Historic reproduction fittings
Max. leaf weight 100 kg, 150 kg on request

System features

Design variants:
Turn/tilt and turn/tilt only windows, single/double leaf, with optional sidelight and fanlight
Fixed glazing
Optionally as a French window
Structural depth: Leaf profile 88 mm, frame profile 70 mm, max. filling element thickness 60 mm
Glazing beads in aluminium and steel
Wet and dry glazing
Surface treatment with hot-dip galvanizing approved

Performance characteristics*

CE/UKCA marking according to EN 14351-1
Thermal insulation: U value up to 0.8 W/(m²·K)
Mechanical load: Class 2 according to EN 12400 (10,000 cycles EN 1191)
Burglary resistance: RC2 according to EN 1627
Resistance to wind loads: Class B5/C5 according to EN 12210
Watertightness: Class E1050 according to EN 12208
Air permeability: Class 4 according to EN 12207
Impact resistance: Class 4 according to EN 13049
Operating forces: Class 2 according to EN 13115
Sound insulation up to $R_w = 47$ dB according to EN ISO 140-3

* Take note of the country-specific approvals and requirements

Material variants

Bright steel
Steel zinc magnesium

Face widths

Window sash with frame from 110 mm
Fixed glazing from 50 mm

Dimensions

Top-hung window:
Max. leaf width: 2378 mm
Max. leaf height: 2378 mm
Max. surface: 1.85 m²
Turning window:
Max. leaf width: 778 mm
Max. leaf height: 1528 mm
Fixed glazing (W×H): unlimited × max. 3000 mm

Fittings

Attached and concealed flush fittings
Historic reproduction fittings
Max. leaf weight 180 kg

System features

Design variants:
Single leaf, with optional sidelight and fanlight
Fixed glazing
Structural depth: Leaf profile 70 mm, frame profile 70 mm, max. filling element thickness 42 mm
Glazing beads in aluminium and steel
Wet and dry glazing
Surface treatment with hot-dip galvanizing approved

Performance characteristics*

CE/UKCA marking according to EN 14351-1
Thermal insulation: U_{2f} value up to 1.2 W/(m·K)
Resistance to wind loads: Class B4/C4 according to EN 12210
Watertightness: Class E1350 according to EN 12208
Air permeability: Class 4 according to EN 12207
Operating forces: Class 1 according to EN 13115
Sound insulation up to $R_w = 34$ dB according to EN ISO 140-3

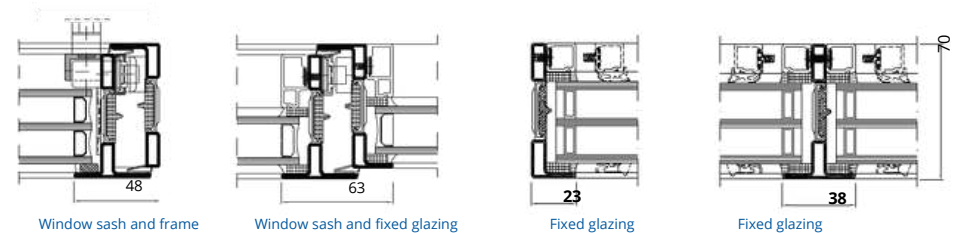

PROFILE SYSTEMS IN STEEL

FORSTER UNICO XS

forster



PROFILE SYSTEMS IN STEEL

DOOR SYSTEM FORSTER UNICO

forster

Technical specifications

Material variants

Steel zinc magnesium

Face widths

Door leaf with frame from 65 mm

Fixed glazing from 23 mm

Dimensions

Inside width single-leaf (W×H): max. 1200 × 2400 mm

Inside width double-leaf (W×H): max. 2400 × 2400 mm

Fittings

Attached fittings

Max. leaf weight 160 kg

System features

Design variants:

Side-hung door with single/double leaf, with optional sidelight and fanlight

Fixed glazing

Insulated door threshold

Structural depth 70 mm

Max. filling element thickness 42 mm

Glazing beads in aluminium and steel

Wet and dry glazing

Performance characteristics*

CE/UKCA marking according to EN 14351-1

Thermal insulation U2D up to 1.3 W/(m.K)

Durability of self-closing properties: Class 6 according to EN 12400 (tested up to 200,000 cycles according to EN 1191)

Doors for escape and emergency routes (partial and full panic) according to EN 179 and EN 1125

Resistance to wind loads: Class B2/C2 according to EN 12210

Watertightness: Class 3A according to EN 12208

Air permeability: Class 3 according to EN 12207

Operating forces: Class 3 according to EN 12217

Barrier-free according to DIN 18040

Sound insulation up to $R_w = 46$ dB according to EN ISO 140-3

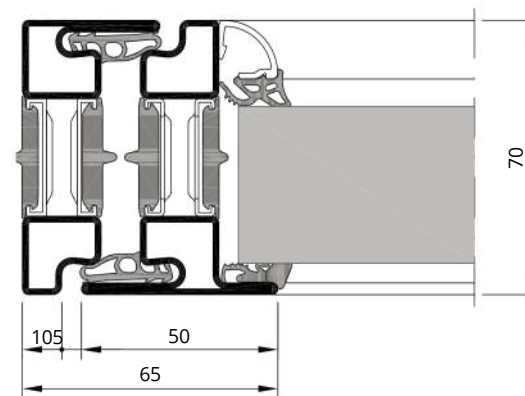

Door leaf frame

PROFILE SYSTEMS IN STEEL

DOOR SYSTEM FORSTER UNICO

forster

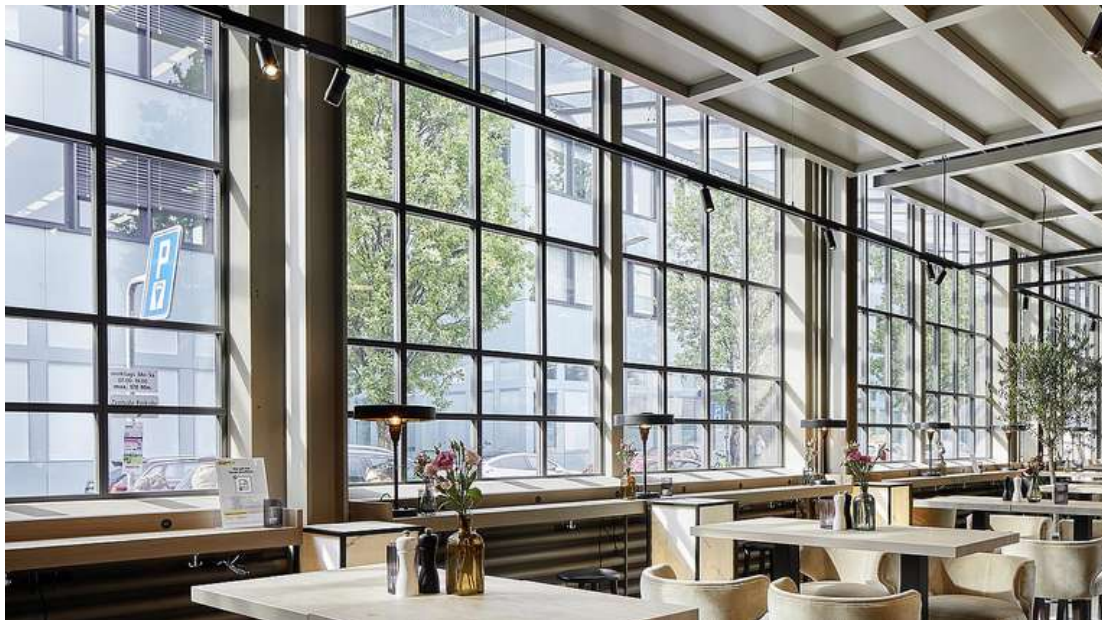

PVC Joinery



Hinged system with 84 mm of frame depth and 6 interior chambers that offers the best thermal performance in the market, with a transmittance value U_w of only $0.66 \text{ W/m}^2\text{K}$. This series has been certified by the Passivhaus Institute for cool- temperate category (cold and temperate weather), becoming an ideal solution for low energy consumption buildings. It includes special insulating foams in the sash and frame, disposing of the steel reinforcement to increase transmittance. The glass itself acts as a structural element of the window, fixed to the profile by a special adhesive tape.

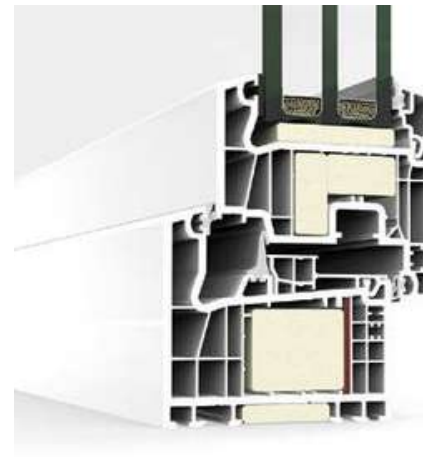
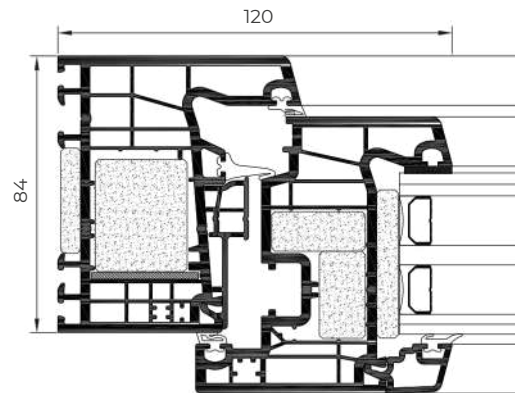

POSSIBILITIES



SECURITY
HARDWARE



CONCEALED
HINGES

Sightlines

Frame 84 mm, Sash 84 mm

Glazing

Max. 56 mm, Min. 36 mm

Maximum Sash Dimensions

Window:

Width (L) 450-1300 mm

Height (H) 450-2200 mm

Balcony:

Width (L) 450-1300 mm

Height (H) 600-2200 mm

Maximum Sash Weight

100 kg

Consult maximum weight and dimensions according to typologies

Aesthetic possibilities:

Sash: Straight / Bead: Straight or curved

FEATURES

| | | |
|---------------------|--|---|
| Transmittance | | $U_w \geq 0.66 \text{ (W/m}^2\text{K)}$ |
| Acoustic insulation | | Rw up to 46 dB |
| Air permeability | | Class 4 |
| Water tightness | | Class E1500 |
| Wind resistance | | Class C5 |

OPENING POSSIBILITIES



Inward Opening

Side hung

Tilt & turn

Bottom hung

Certified for the warm-temperate category (warm-temperate weather), it offers a transmittance value U_w of $0.74 \text{ W/m}^2\text{K}$, thanks to the use of an internal reinforcement with thermal break.

FEATURES

| | | |
|---------------------|--|---|
| Transmittance | | $U_w \geq 0.74 \text{ (W/m}^2\text{K)}$ |
| Acoustic insulation | | R_w up to 46 dB |
| Air permeability | | Class 4 |
| Water tightness | | Class E1500 |
| Wind resistance | | Class C5 |

Reference test 1.23 x 1.48 m / 2 sashes

Aesthetic possibilities:

Sash: Straight

Bead: Straight or curved

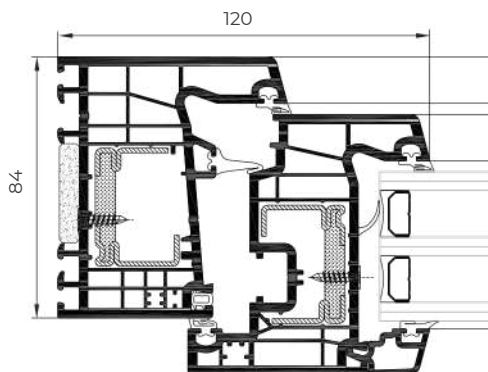

Passivhaus 1.0 Thermally broken

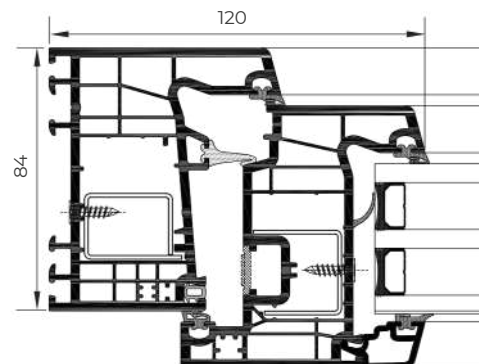

Passivhaus 1.0

POSSIBILITIES



SECURITY
HARDWARE



CONCEALED
HINGES

OPENING POSSIBILITIES

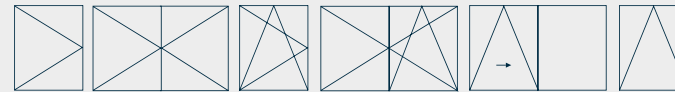

Inward Opening

Side hung

Tilt & turn

Tilt & parallel

Bottom hung

Sightlines

Frame 84 mm, Sash 84 mm

Glazing

Max. 54 mm, Min. 18 mm

Maximum Sash Dimensions

Window:

Passivhaus 1.0 Thermally broken:

Width (L) 450-1400 mm

Passivhaus 1.0 reduced reinforcement:

Width (L) 450-1300 mm

Passivhaus 1.0 Thermally broken

Passivhaus 1.0 reduced reinforcement:

Height (H) 450-2200 mm

Balcony passivhaus 1.0:

Width (L) 450-1400 mm

Height (H) 600-2400 mm

Maximum Sash Weight

130 kg

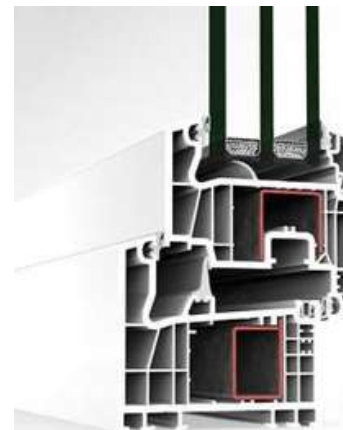

A 84

Hinged



Hinged system with a 84 mm frame depth and 6 interior chambers with excellent thermal performance, U_w from 0.79 W/m^2K , and a great acoustic performance thanks to its glazing capacity of up to 54 mm.

FEATURES

| | | |
|---------------------|--|--------------------------|
| Transmittance | | $U_w \geq 0.79 (W/m^2K)$ |
| Acoustic insulation | | Rw up to 46 dB |
| Air permeability | | Class 4 |
| Water tightness | | Class E1500 |
| Wind resistance | | Class C5 |

Reference test 1.23 x 1.48 m / 2 sashes

POSSIBILITIES



OPENING POSSIBILITIES

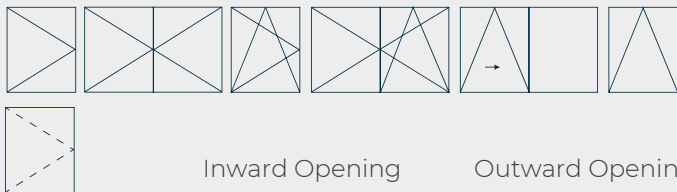

Inward Opening

Outward Opening

Side hung
Tilt & turn
Tilt & parallel
Bottom hung

Side hung (Door)

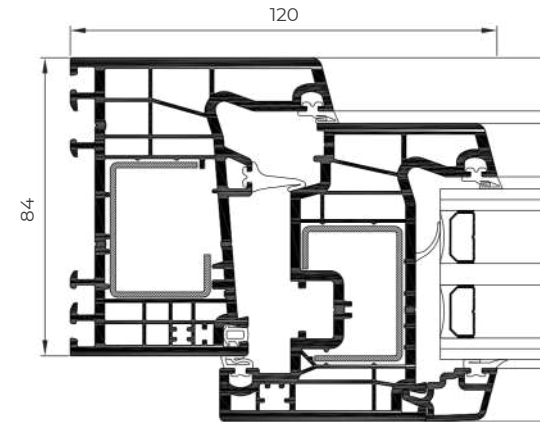

Sightlines

Frame 84 mm

Sash 84 mm

Glazing

Max. 54 mm, Min. 4 mm

Maximum Sash Dimensions

Window:

Width (L) 450-1400 mm

Height (H) 450-2450mm

Balcony:

Width (L) 450-1400 mm

Height (H) 600-2500 mm

Door:

Width (L) 700-1300 mm

Height (H) 600-2500 mm

Maximum Sash Weight

130 Kg Window / Balcony

160 Kg Door

Aesthetic possibilities:

Sash: Straight

Bead: Straight or curved



Consult maximum weight and dimensions according to typologies

A 84 PASSIVHAUS



A 84 HIDDEN SASH

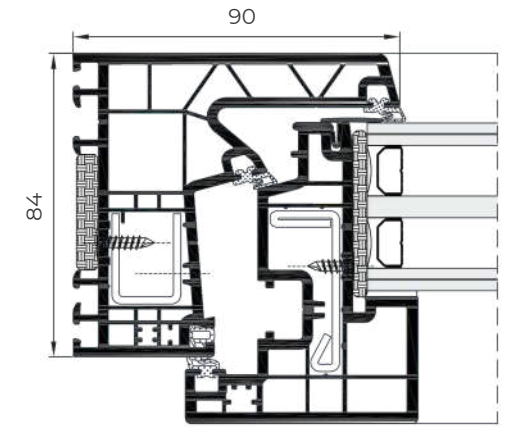

A 84 Hidden Sash Passivhausvhaus

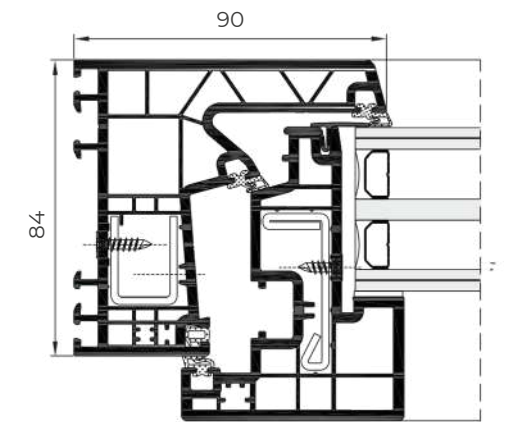

A 84 Hidden Sash

Minimalist window with a lateral sightline of only 90 mm and possibility of reduced central sightline of the same measure. This system with 84 mm of frame depth and 6 interior chambers combines elegant design with excellent thermal performance, in the Passivhaus version certified for the warm- temperate category (U_w from 0.71 W/m^2K) as well as in the standard version (U_w from 0.74 W/m^2K).



A 84 Hidden Sash Passivhaus



A 84 Hidden Sash

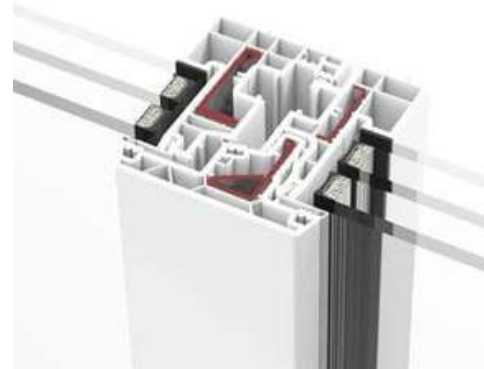

Possibility of 90 mm interlock section



Sightlines

Frame 84 mm, Sash 84 mm

Glazing

Max. 46.5 mm, Min. 32 mm

Glazing: 46.5 mm (Passivhaus)

Maximum Sash Dimensions

Width (L) 400-1400 mm

Height (H) 450-2500 mm

Maximum Sash Weight

130 Kg Window / Balcony

Consult maximum weight and dimensions according to typologies

FEATURES

Transmittance Passivhaus $U_w \geq 0.71 (W/m^2K)$

Transmittance Standard $U_w \geq 0.74 (W/m^2K)$

Acoustic insulation R_w up to 46 dB

Air permeability Class 4

Water tightness Class E2250

Wind resistance Class C5

Reference test 1.23 x 1.48 m / 2 sashes

POSSIBILITIES



SECURITY HARDWARE



CONCEALED HINGES



ACCESSIBILITY (A 84 HIDDEN SASH)



CONCEALED DRAINAGE (A 84 HIDDEN SASH)

OPENING POSSIBILITIES



Inward Opening

Side hung
Tilt & turn
Bottom hung

A 70

Hinged



Hinged system with 70 mm of frame depth with a maximum glazing capacity of 42 mm. The 5 interior chambers in the frame and sash allows for great energy efficiency with a transmittance value U_w from 0.9 W/m²K. Possibility of straight, curved or chamfered sashes.



Straight Sash



Chamfered Sash



Curved Sash

Sightlines

Frame 70 mm

Sash 70 / 80 mm

Glazing

Max. 42 mm / Min. 4 mm

Maximum Sash Dimensions

Window:

Width (L) 360 - 1300 mm

Height (H) 450 - 2300 mm

Balcony:

Width (L) 360 - 1300 mm

Height (H) 600 - 2400 mm

Door:

Width (L) 700 - 1300 mm

Height (H) 600 - 2500 mm

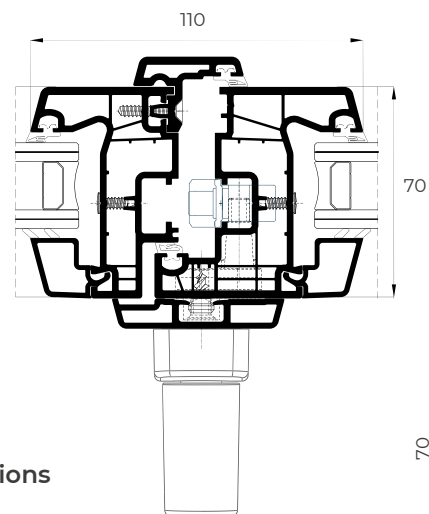

70 Possibility of centred handle

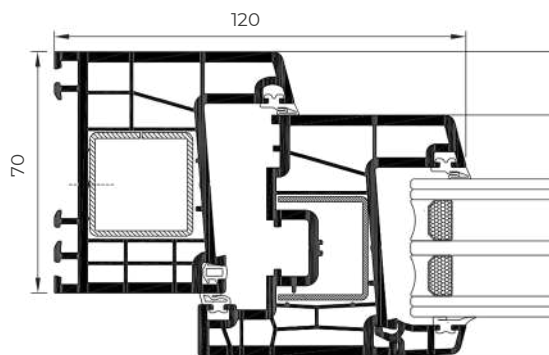

Maximum Sash Weight

130 kg Window

130 Kg Balcony

160 Kg Door

Aesthetic possibilities

Sash: Straight, curved or chamfered

Bead: Straight or curved

Consult maximum weight and dimensions according to typologies

OPENING POSSIBILITIES



Outward Opening

Side hung (Door)

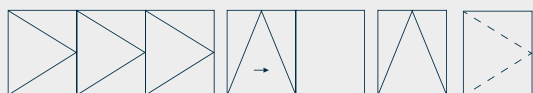

Inward Opening

Side hung

Tilt & turn

Bi-fold

Tilt & parallel

Bottom hung

POSSIBILITIES



SECURITY HARDWARE



ACCESSIBILITY



CONCEALED DRAINAGE

FEATURES

Transmittance



$U_w \geq 0.9$ (W/m²K)

Acoustic insulation



Rw up to 46 dB

Air permeability



Class 4

Water tightness



Class E1800

Wind resistance



Class C5

Reference test 1.23 x 1.48 m / 2 sashes CSTB Laboratory DTA Certification

A 70 HINGED

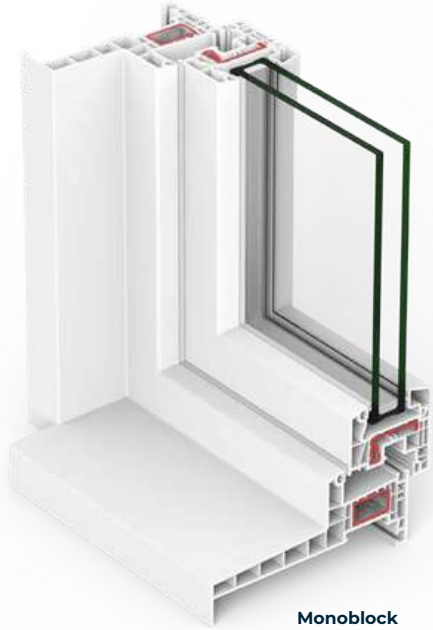

Monoblock

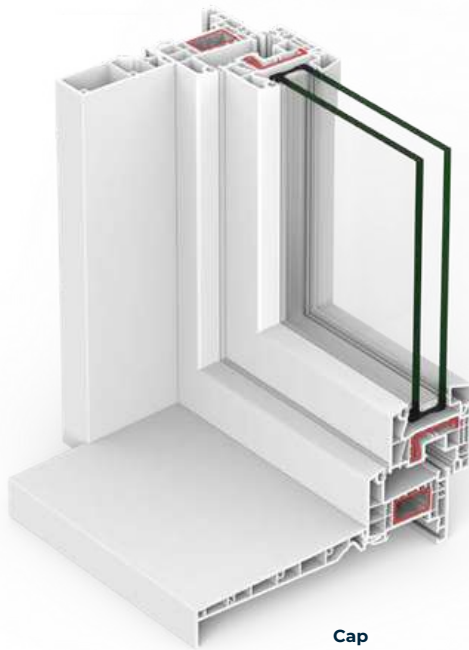
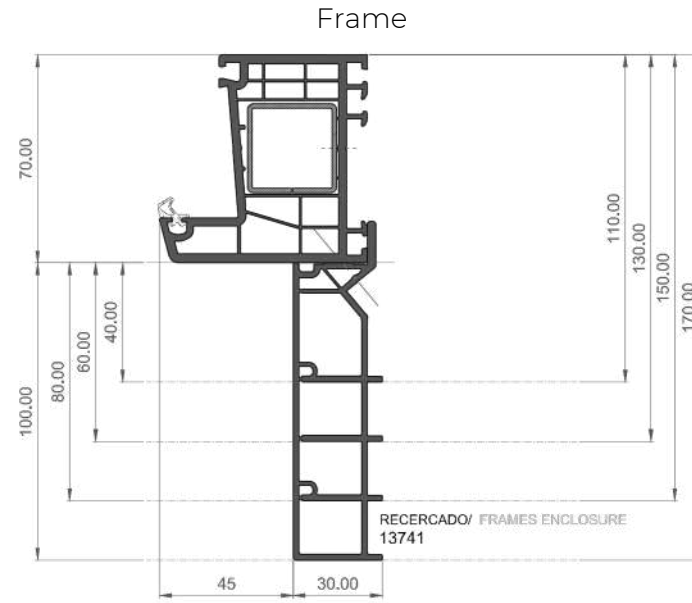

Cap

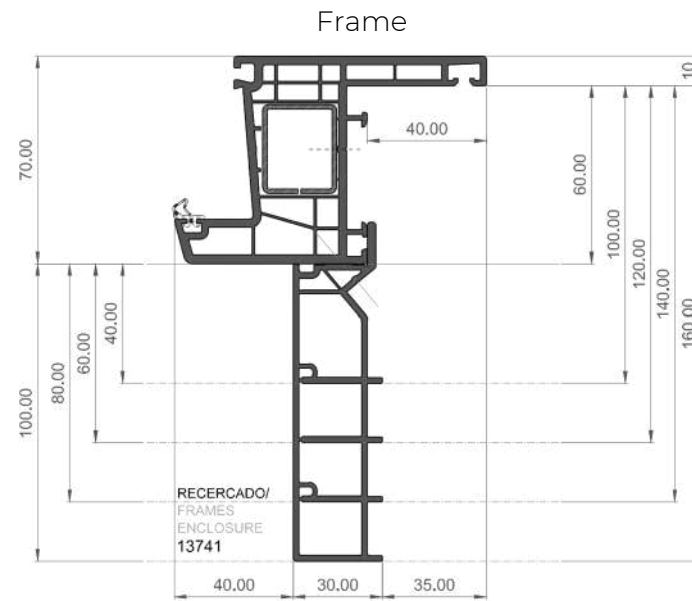

CORTIZO QUALITY PVC

Class A

Main walls thickness:
3 mm



Class S

Climatic zones

7 parts of titanium dioxide.
Maximum resistance to solar
incidence

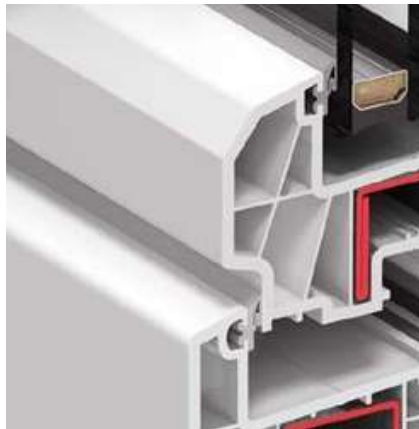

Class II

Impact resistance

Maximum profile hardness

A 70 HINGED



ALCOVER

Mixed window system that multiplies the aesthetic possibilities of the PVC A 70 series, covering the external face of the window with an aluminium profile clipped on the frame and sash, with 45° or 90° profile encounters. This solution, ideal for rehabilitation, allows the combination of the excellent performance of PVC systems and the great variety of powder-coated and anodized finishes aluminium offers.

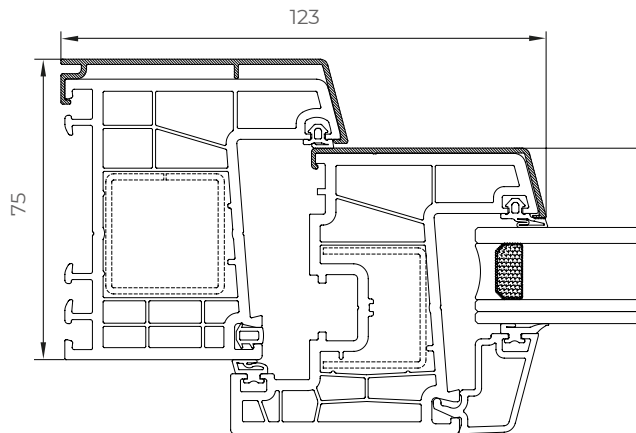

OPENING POSSIBILITIES



Inward opening
Side hung
Tilt & turn
Bottom hung

FEATURES

| | | |
|---------------------|--|-------------------------------------|
| Transmittance | | $U_w \geq 0.9$ (W/m ² K) |
| Acoustic insulation | | Rw up to 46 dB |
| Air permeability | | Class 4 |
| Water tightness | | Class E1800 |
| Wind resistance | | Class C5 |

Reference test 1.23 x 1.48 m / 2 sashes

POSSIBILITIES



SECURITY
HARDWARE



Alcover 45° profile encounters



Alcover 90° profile encounters

Sightlines

Frame 75 mm, Sash 71 mm

Glazing

Max. 42 mm, Min. 18 mm

Maximum Sash Dimensions

Window:

Width (L) 360 - 1300 mm

Height (H) 450 - 2300 mm

Balcony:

Width (L) 360 - 1300 mm

Height (H) 600 - 2400 mm

Maximum Sash Weight

130 kg Window

130 Kg Balcony

Consult maximum weight and dimensions according to typologies







C 70

Sliding



Sliding window and balcony system with 70 mm of frame depth and optimal thermal and acoustic performances. Possibility of minimalist sash with only 30 mm of interlock profile.

FEATURES

| | | |
|---------------------|---|-------------------------------------|
| Transmittance |  | $U_w \geq 1.3$ (W/m ² K) |
| Acoustic insulation |  | Rw up to 38 dB |
| Air permeability |  | Class 4 |
| Water tightness |  | Class 7A |
| Wind resistance |  | Class C5 |

Reference test 1.23 x 1.48 m / 2 sashes

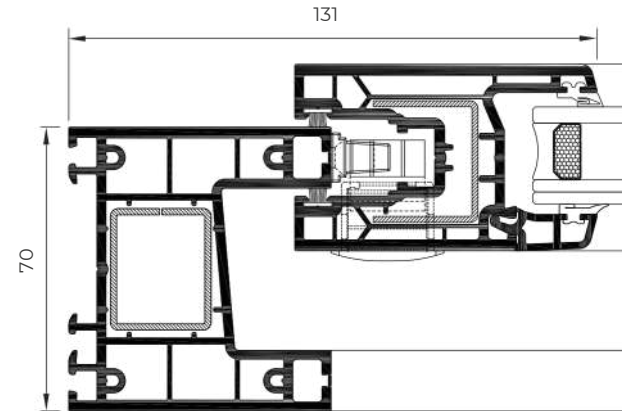

POSSIBILITIES



SECURITY
HARDWARE



ACCESSIBILITY

OPENING POSSIBILITIES



Sliding

Sightlines

Frame 70 mm, Sash 46 mm

Glazing

Max. 26 mm, Min. 4 mm

Maximum Sash Dimensions

Window:

Width (L) 1400 mm

Height (H) 1800 mm

Balcony:

Width (L) 1800 mm

Height (H) 2600 mm

Maximum Sash Weight

70 kg Window

200 Kg Balcony



Consult maximum weight and dimensions according to typologies

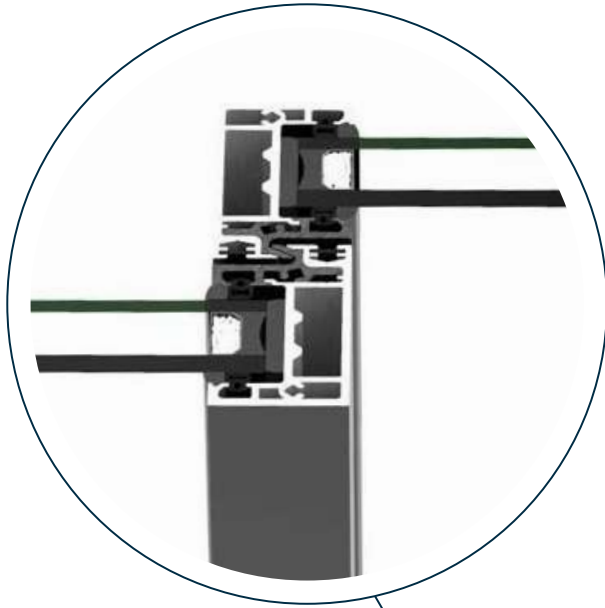

SLIM CENTRAL SECTION

Possibility of **slim central section** of 30 mm

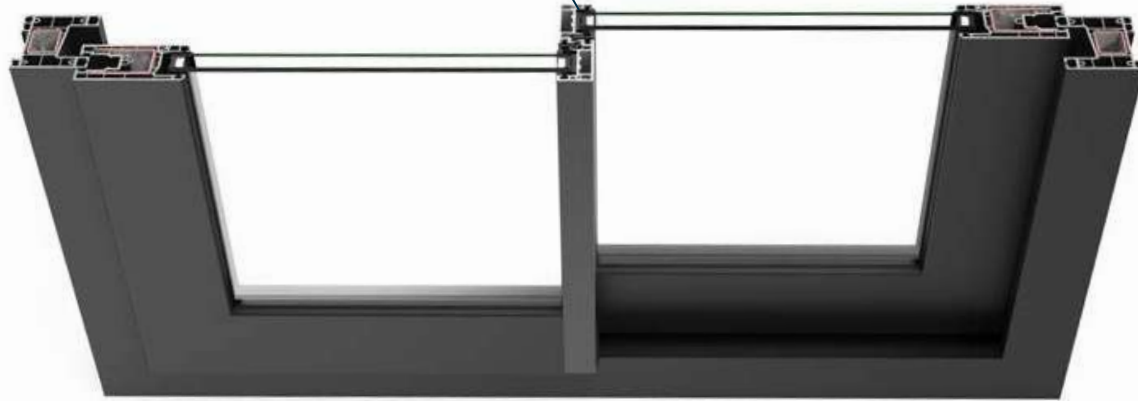

SLIDING **C 70**

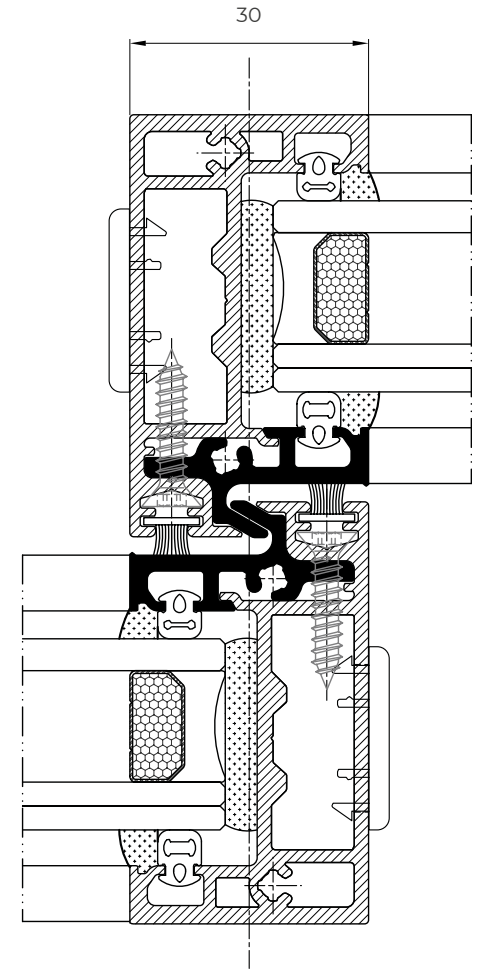

SYNEGO from REHAU is labeled as an EcoPuls product. This means that the window profile contains more than 40% recycled materials. REHAU represents this positive ecological footprint. Enjoy the comfort of your windows and the pleasant feeling of having chosen a sustainably manufactured product.

FEATURES

Transmittance  $U_w \geq 0,9$ (W/m²K)

Acoustic insulation  R_w up to 37 dB

Air permeability  Class 4

Water tightness  Class 9A

Wind resistance  Class B5

Essai de référence AEV 1,23 x 1,48 m / 2 vantaux

POSSIBILITIES

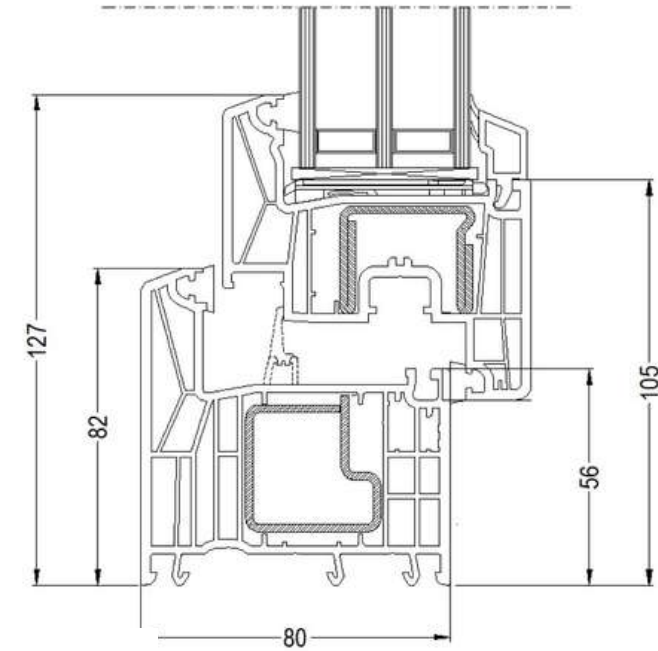

Constructive depth:

80mm

Glazing

Max. 51mm

Consult maximum weight and dimensions according to typologies

SYNEGO

Alu covered



SYNEGO from REHAU is labeled as an EcoPuls product. This means that the window profile contains more than 40% recycled materials. REHAU represents this positive ecological footprint. Enjoy the comfort of your windows and the pleasant feeling of having chosen a sustainably manufactured product.

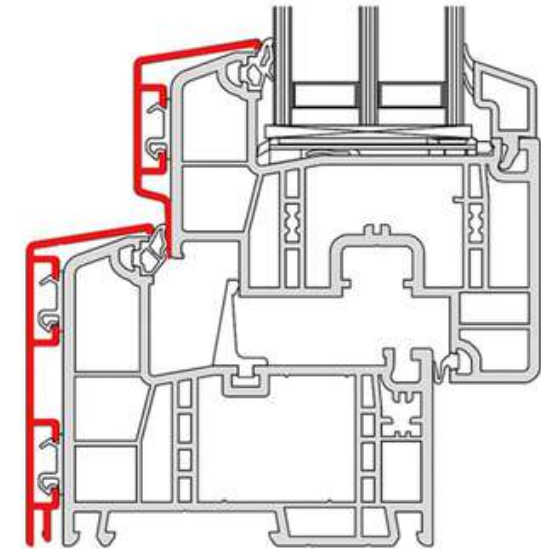

FEATURES

Transmittance  $U_w \geq 0,9$ (W/m²K)

Acoustic insulation  R_w up to 37 dB

Air permeability  Class 4

Water tightness  Class 9A

Wind resistance  Class B5

Essai de référence AEV 1,23 x 1,48 m / 2 vantaux



Constructive depth:

80mm

Glazing

Max. 51mm

POSSIBILITIES



SECURITY
HARDWARE

Consult maximum weight and dimensions according to typologies

PVC DOOR HANDLES



**HANDLE
WITCH SHIELD DG58**



**HANDLE
WITH SHIELD AND BUTTON
DG58**



**HANDLE
DG61**



**HANDLE
SPACE TG10**

PVC WINDOW HANDLES



**HANDLE
ROTO SWING**



**HANDLE
GREENTEQ FG10
WITH KEY**



**HANDLE
GREENTEQ FG10
WITH BUTTON**



**HANDLE
HOPPE TOULON
SECUFORTE**



**HANDLE
HOPPE STUTTGART**

Color options for PVC joinery



Standard colors



Ultra performance colors

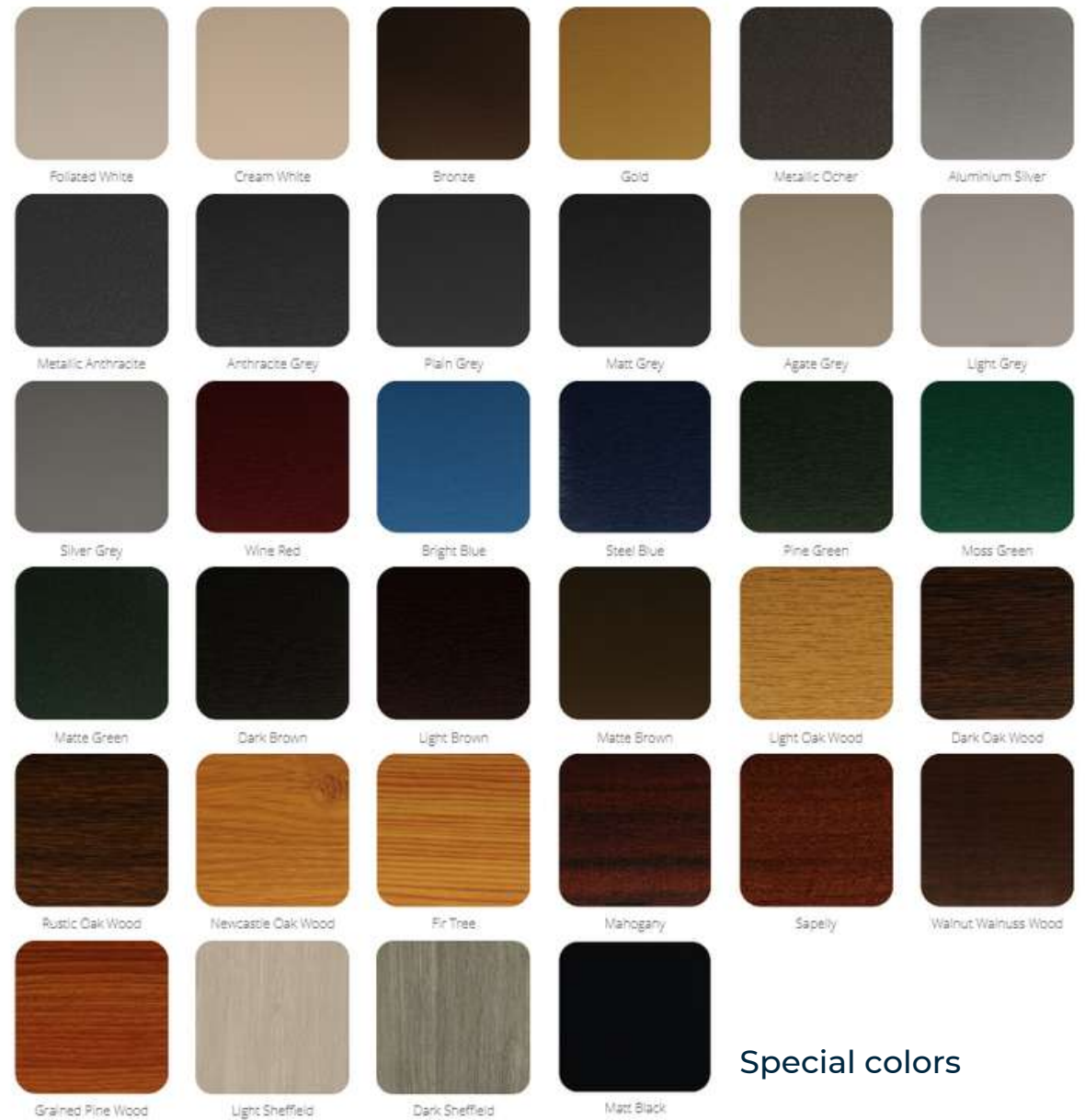

Special colors

Wood Joinery



TERMO 92

Wooden profile from various essences with a section of 92/80mm, triple-layered (three layers of wood);
The glass is usually made up of an insulated glass package 24 mm bipan;
The carpentry is equipped with Maco hardware (depending on the type of opening);
A teardrop made of brown aluminum is installed. It is provided with drainage holes and on profiled rubber ends, for the direction of the water drop;
The wood essences used for the construction of the windows are the following:
Spruce, Pine, Larch, Oak and Meranti;
The wood is treated in its own thermal chamber, and after processing it is treated with special impregnants;
The carpentry is equipped with special gaskets for each profile;
The sealing between the glass and the wooden profile is made with special silicone, of various chromatic shades, by moistening, to ensure total perimeter sealing;
The finishes are of high quality and resistance, having calculated the degree of glossiness, elasticity, as well as weather resistance;



FEATURES

Transmittance



$U_w \geq 0,8$ (W/m²K)

Acoustic insulation



R_w up to 42 dB

TERMO 78

Wooden profile from various essences with a section of 78/80mm, triple-layered (three layers of wood);

The glass is usually made up of an insulated glass package 24 mm bipan;

The carpentry is equipped with Maco hardware (depending on the type of opening);

A teardrop made of brown aluminum is installed. It is provided with drainage holes and on profiled rubber ends, for the direction of the water drop;

The wood essences used for the construction of the windows are the following:

Spruce, Pine, Larch, Oak and Meranti;

The wood is treated in its own thermal chamber, and after processing it is treated with special impregnants;

The carpentry is equipped with special gaskets for each profile;

The sealing between the glass and the wooden profile is made with special silicone, of various chromatic shades, by moistening, to ensure total perimeter sealing;

The finishes are of high quality and resistance, having calculated the degree of glossiness, elasticity, as well as weather resistance;



FEATURES

Transmittance



$U_w \geq 0,9$ (W/m²K)

Acoustic insulation



R_w up to 41 dB

TERMO 68

Wooden profile made of various essences with a section of 68/80mm, triple-layered (three layers of wood);

The glass is usually made up of an insulated glass package 24 mm bipan;

The carpentry is equipped with Maco hardware (depending on the type of opening);

A teardrop made of brown aluminum is installed. It is provided with drainage holes and on profiled rubber ends, for the direction of the water drop;

The wood essences used for the construction of the windows are the following:

Spruce, Pine, Larch, Oak and Meranti;

The wood is treated in its own thermal chamber, and after processing it is treated with special impregnants;

The carpentry is equipped with special gaskets for each profile;

The sealing between the glass and the wooden profile is made with special silicone, of various chromatic shades, by moistening, to ensure total perimeter sealing;

The finishes are of high quality and resistance, having calculated the degree of glossiness, elasticity, as well as weather resistance;



FEATURES

Transmittance



$U_w \geq 0,8$ (W/m²K)

Acoustic insulation



R_w up to 41 dB



SHADING SYSTEMS



EXTERIOR BLINDS

Exterior blinds, together with roller shutters, compared to internal shading technology, offer a higher level of protection against solar radiation due to the reduction of light and heat already present inside.

Cetta 80

| | Head Rail | | Bottom Rail | Slat | Side Guidance | | Ladder | Textile Band |
|------------------------|--|------------|--|--------------|---------------|--|-------------|--------------|
| | 56 x 58 Fe | 58 x 60 Al | 80 x 13 Al | 0,42 x 98 Al | Steel Wire | Guiding Channel | 68 x 85 PES | 6 x 0,28 PES |
| Commercial Name | | | | | ∅ 3,2 Fe/PVC | Variants of guiding channels in Chapter "Guides" | | |
| Dimension (mm) | | | | | | | | |
| Material | | | | | | | | |
| Color | Standard: Galvanized steel plate natural (Al profil) Other RAL colors sprayed, DECORAL* | | Standard: anodized aluminium Other RAL colors sprayed, DECORAL* | | grey black | Basic design - anodized Varnished in RAL colors, DECORAL* | grey black | grey black |

*Maximum dimension 4000mm.

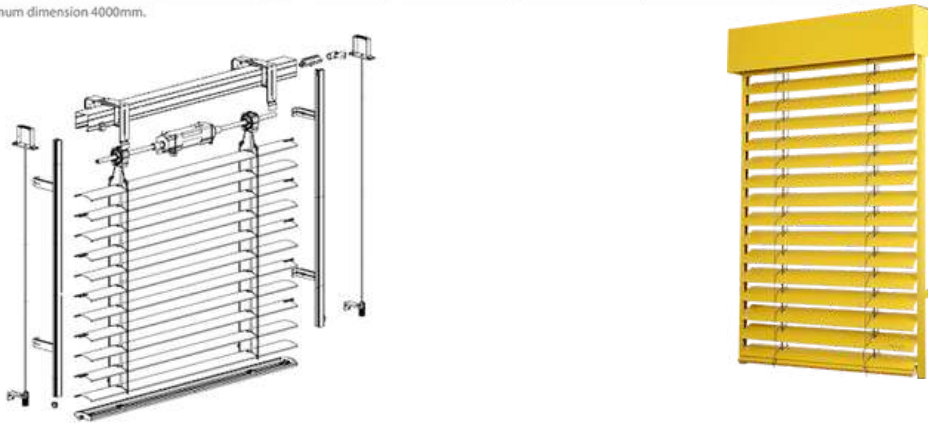

Zetta 90

| | Head Rail | | Bottom Rail | Slat | Side Guidance | | Ladder | Textile Band |
|------------------------|--|------------|--|---------------|--|--------------|--------------|--------------|
| | 56 x 58 Fe | 58 x 60 Al | 93 x 14 Al | 0,42 x 113 Al | Guiding Channel | Wire | 80 x 9,5 PES | 6 x 0,28 PES |
| Commercial Name | | | | | See Chapter "Guidance" for guiding channel alternatives | ∅ 3,2 Fe/PVC | | |
| Dimension (mm) | | | | | | | | |
| Material | | | | | | | | |
| Color | Standard: galvanized steel plate natural (Al profil) Other RAL colors sprayed, DECORAL* | | Standard: anodized aluminium Other RAL colors sprayed, DECORAL* | | Standard: anodized Other RAL colors sprayed, DECORAL* | grey black | grey black | grey black |

*Maximum dimension 4000mm.

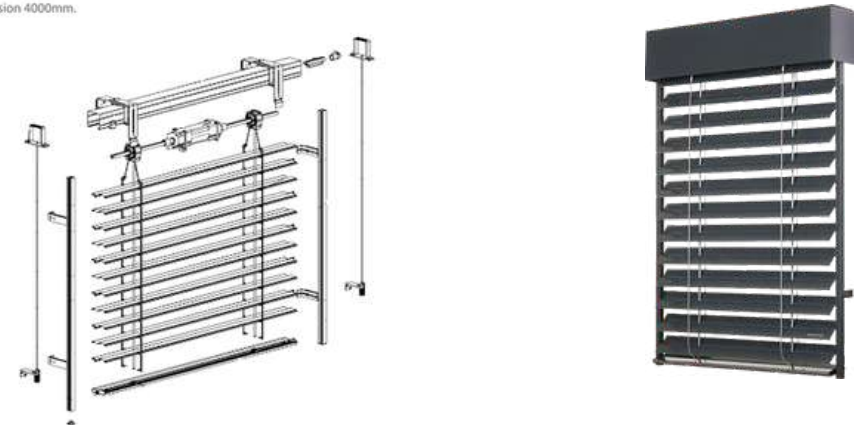

Color Codes



Side hung shutter system with fixed or adjustable louvres

FEATURES

Thermal resistance of the shutter
and the thermal chamber



$\Delta R = 0,08 \text{ (m}^2\text{K/W)}$

Wind resistance



Class 5

Reference test 1,50 x 1,50 m / 2 sashes

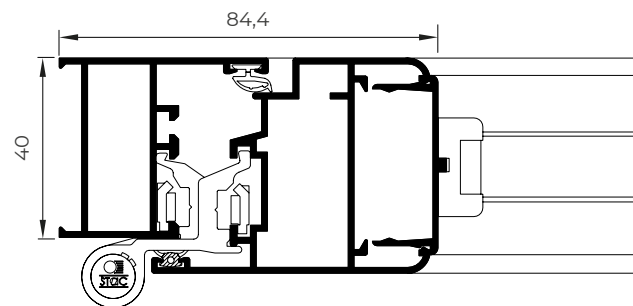

U_w(W/m²K) U_{ws}(W/m²K)

| | |
|-----|------|
| 0,8 | 0,75 |
| 1,0 | 0,93 |
| 1,2 | 1,09 |
| 1,4 | 1,26 |
| 1,6 | 1,42 |
| 1,8 | 1,57 |
| 2,0 | 1,72 |
| 2,2 | 1,87 |
| 2,4 | 2,01 |
| 2,6 | 2,15 |
| 2,8 | 2,29 |
| 3,0 | 2,42 |
| 3,2 | 2,55 |

OPENING POSSIBILITIES



Side hung of 1, 2, 3 and 4 sashes

Sightlines

Frame 40 mm

Sash 48 mm

Profile Thickness

Window 1,3 mm

Door 1,4 mm

Maximum Sash Weight

75 Kg

Maximum Sash Dimensions

Width (L) 1500 mm

Height (H) 2400 mm



Side hung, sliding or bifold shutter system with fixed or adjustable louvres.

FEATURES

Thermal resistance of the shutter and the thermal chamber

 $\Delta R = 0,08 \text{ (m}^2\text{K/W)}$

Wind resistance

 Class 5

Reference test 1,50 x 1,50 m / 2 sashes

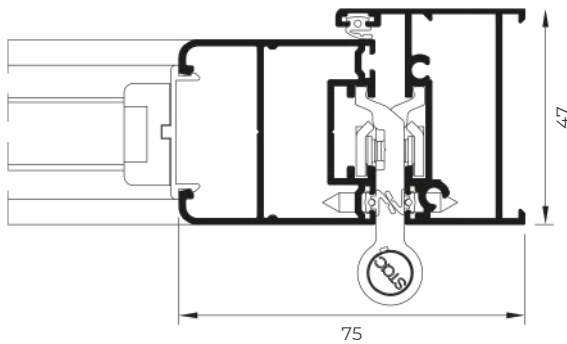

Sightlines

Frame 47 mm

Sash 40 mm

Profile Thickness

Window 1,3 mm

Door 1,5 mm

Maximum Sash Weight

Side hung 65 kg

Bifold 50 kg

Sliding 120 kg

Maximum Sash Dimensions

Side hung:

Width (L) 1600 mm, Height (H) 2500 mm

Bifold:

Width (L) 700 mm, Height (H) 2500 mm

Sliding:

Width (L) 2000 mm, Height (H) 3500 mm

Transmittance

Uw window transmittance

Uws transmittance of the window-shutter system

| Uw(W/m ² K) | Uws(W/m ² K) |
|------------------------|-------------------------|
| 0,8 | 0,75 |
| 1,0 | 0,93 |
| 1,2 | 1,09 |
| 1,4 | 1,26 |
| 1,6 | 1,42 |
| 1,8 | 1,57 |
| 2,0 | 1,72 |
| 2,2 | 1,87 |
| 2,4 | 2,01 |
| 2,6 | 2,15 |
| 2,8 | 2,29 |
| 3,0 | 2,42 |
| 3,2 | 2,55 |



Closing possibilities

Closing with fixed or adjustable louvres

Opaque closing (sandwich panel)

Glazed closing

OPENING POSSIBILITIES



Side hung
Sliding
Bifold

TAMIZ



OPENHOUSE FRANGISOLE

Aluminum structure in White, Ivory, Brown colors, Anthracite.
Slats in painted aluminum 180.9 mm.
Slat orientation from 0 ° to 130 °.
winch movement (standard) or motor (optional)
Minimum slope for 5% water outflow.
Wind resistance class 4.
Water discharge inside the legs.
Protection from rain, sun and high resistance to atmospheric agents.
Possibility to realize modular covers and to close the sides with Tcl.
curtains - Wall mount; legs height 230 cm.

Maximum recommended dimensions per module:

- Width 300 cm with a standard plate
- Width 400 cm with a reinforced plate
- Projection 605 cm

For more pergola and awning designs, check out the **Shading Systems Catalog**.





SOLAR PROTECTION LOUVRES

Efficient solution for solar ray incidence control in the building's interior temperature. Solar radiation is absorbed and reflected by these external louvres, facilitating energy efficiency and decreasing the need for artificial refrigeration. In addition, they serve as a decorative element bringing an avant-garde aesthetic to the façade.

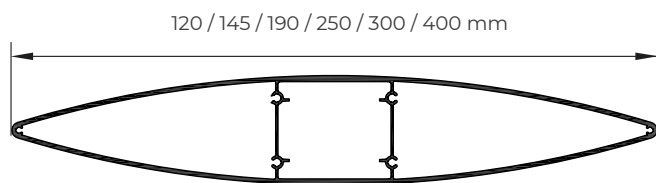

Profile Thickness

| Louvres | Thickness |
|---------|-----------|
| 120 mm | 1,25 mm |
| 145 mm | 1,35 mm |
| 190 mm | 1,70 mm |
| 250 mm | 1,90 mm |
| 300 mm | 2,00 mm |
| 400 mm | 2,50 mm |



Louvre type

Fixed: Regulation 0°, 15°, 30° or 45°.

Adjustable: Motorized and manual.

| Louvre size | Max recommended length to fixed louvres | Maximum recommended length to adjustable louvres |
|-------------|---|--|
| 120 mm | 1,8 metres | |
| 145 mm | 2,2 metres | 1,9 metres |
| 190 mm | 2,5 metres | 2,4 metres |
| 250 mm | 3,0 metres | 3,0 metres |
| 300 mm | 3,5 metres | 3,4 metres |
| 400 mm | 4,2 metres | 4,0 metres |



Wind load resistance Class 6 (max.)

Reference test

| Louvres | Length |
|---------|------------|
| 120 mm | 1,8 metres |
| 145 mm | 2,0 metres |
| 190 mm | 2,5 metres |
| 250 mm | 3,0 metres |
| 300 mm | 3,5 metres |
| 400 mm | 4,2 metres |

Depending on project specifications a larger free louvre length will be attainable (Consult)

Test carried out according UNE 1932

ROLLER SHUTTERS

The **superimposed roller shutters** are made of aluminum with a PVC box of 160mm or 200mm depending on the height; Aluminum slat apron (double-walled lacquered aluminum slats 39, 45, 55 or 77 mm, polyurethane foam filling), standard PVC or aluminum slides on request for aluminum joinery; Final blade in extruded and lacquered aluminum, equipped with a rubber seal; The boxes and side slides are protected with an adhesive sheet which can be removed during installation or afterwards; Types of operation: manual (with strap or crank), wired (with switch), radio (with remote control); All elements are electrostatic field dyed; The motorization is Somfy of 10, 13, 15, 20 newtons, depending on the dimensions.

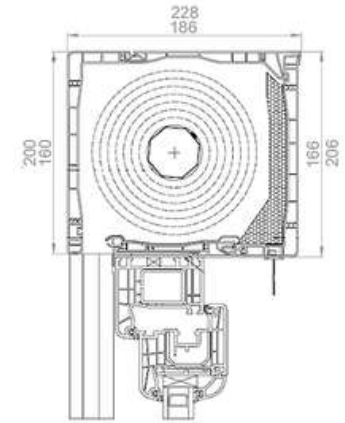

Aluminium blade colors



PVC box colors

ROLLER SHUTTERS

Renovation roller shutters - applied to the exterior - slats 39 mm, 45, 55, 77 mm;

Aluminum slides - dimensions 53 x 22 mm;

Types of operation: manual (with strap or crank), wired (with switch),
radio (with remote controls);

All elements are electrostatic field dyed;

The engine is Somfy;

Standard colors: white, brown and dark brown, but also other colors on
demand (prices increase on color);

Box 137, 165, 205 mm aluminum cut or rounded pan on request (the price
increases on rounded box).

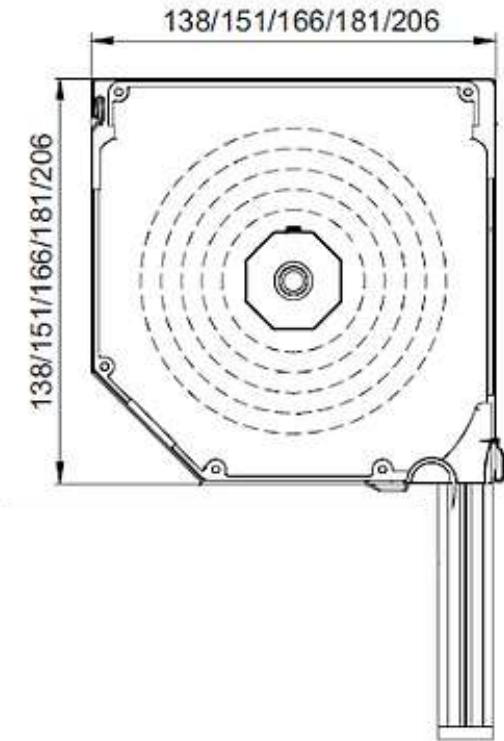

01 SILVER



09 BROWN



22 MAHOGANY



02 WHITE



13 GREEN



23 ANTHRACITE



03 GREY



15 CREAM



30 WALNUT



04 DARK BEIGE



16 IVORY



48 GOLDEN OAK



05 BEIGE



19 BORDO



08 DARK BROWN



20 BLACK



34 WENGE

ROLLER SHUTTERS

Exterior **plasterable roller shutters** are a modern solution used in newly constructed buildings, as well as existing buildings - it is a perfect product for those who care about being energy efficient.

This new system differs from other shutter systems by its mounting method: the shutters are mounted in front of the window, thus we avoid any possible empty space above the window. The integrated components of IT2000 roller shutters do not interfere with the construction of the window, door or lintel, and thus do not break the seal of the building structure. The integrated roller shutter box is not visible, while the inspection hatch, bar and guides can be colored to match the windows.

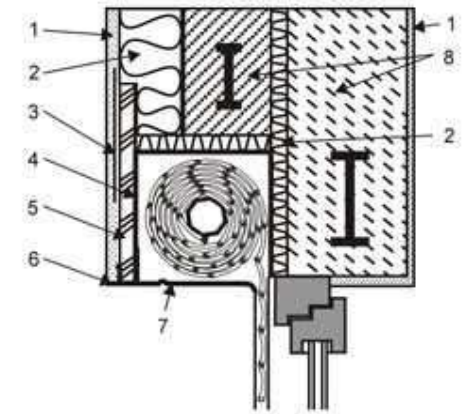
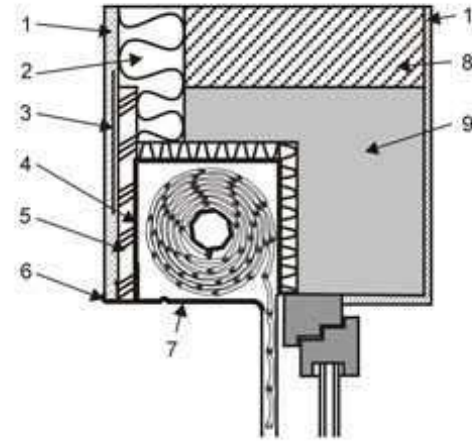

1. plaster
2. thermal insulation
3. reinforcement fabric
4. aluminum trunk
5. insulating panel
6. hood
7. inspection hatch
8. lintel structure
9. concrete



01 SILVER



09 BROWN



22 MAHOGANY



02 WHITE



13 GREEN



23 ANTHRACITE



03 GREY



15 CREAM



30 WALNUT



04 DARK BEIGE



16 IVORY



48 GOLDEN OAK



05 BEIGE



19 BORDO



08 DARK BROWN



20 BLACK



34 WENGE

GLASS FAÇADES





TP 52 FAÇADE

TP 52

FAÇADE

Light façade system composed of 52 mm mullions and transoms that form the support structure. The glass is fixed at its four sides by a continuous pressure profile that is externally screwed to the screw ports incorporated in the mullions and transoms, concealing the entire fixing system under an embellishing profile or cover with an interlock profile of 52 mm.



Glazing

Max. 64 mm, Min. 4 mm

Sightlines

Mullion 52 mm

Transom 52 mm

Profile Thickness

Mullion 2,1 and 3,0 mm

Transom 2,1 mm

Thermal Break Zone

6, 12 and 30 mm stackable profiles

Cover

85 mm deep elliptical cover

H shape cover, 34 mm deep

Rectangular cover: 14, 19 100 & 145 mm deep

Flat cover

Pyramid shape cover, 155 mm deep

Minimum / Maximum opening dimensions

Hidden Top Hung:

Width (L) 2500 - 500 mm, Height (H) 2500 - 650 mm

Hidden Side Hung / Tilt & Turn:

Width (L) 1400-500 mm, Height (H) 1900-600 mm

Hidden Parallel:

Width (L) 1500-450 mm, Height (H) 3000-650 mm

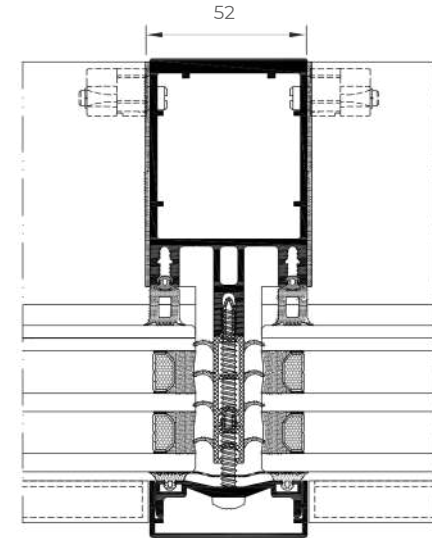

OPENING POSSIBILITIES

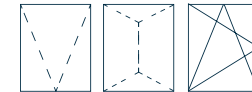

Outward Opening

Hidden top hung
Hidden parallel

Inward Opening

Hidden side hung / tilt & turn

Maximum Weight

200 kg Parallel opening

180 kg Hidden top hung opening

100 Kg Tilt & turn opening

750 Kg Fixed glazing

| FEATURES | | |
|-------------------|--|--|
| Transmittance | | $U_{cw} \geq 0,6$ (W/m ² K) |
| Air permeability | | Class AE |
| Water tightness | | Class RE1350 |
| Wind resistance * | | Passed |

Reference test 3,00 x 3,50 m

Certification CWCT British Standard

* Design loading 2000 Pa-Security loading 3000 Pa



INTERIOR DIVISIONS SYSTEMS





PW80 OFFICE PARTITION WALL

Designed to divide interior spaces, available in glass and panel version. This solution allows the integration of side hung doors and venetian blinds.

FEATURES

Acoustic insulation  Rw up to 48 dB

Mechanical Performance  Category IV

Category IV reference test according to section 2.2.6 of EAD 210005-00-0505

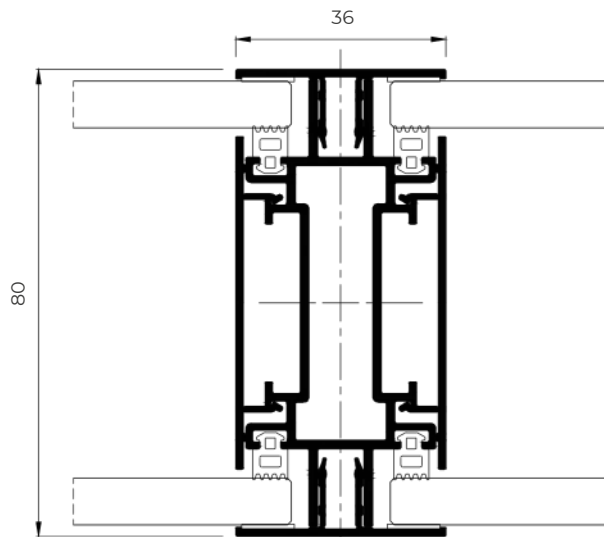

Sections

80 mm (mullion)

Profile thickness

1,5 mm (mullion)

Sightlines

12 / 24 / 36 mm

Panel

10 - 20 mm

Glazing

6+6, 8+8, 10+10, 12+12 mm

Máx. weigh

40 kg

Opening possibilities

8 and 10 mm Glass side hung door

40 mm Panel side hung door

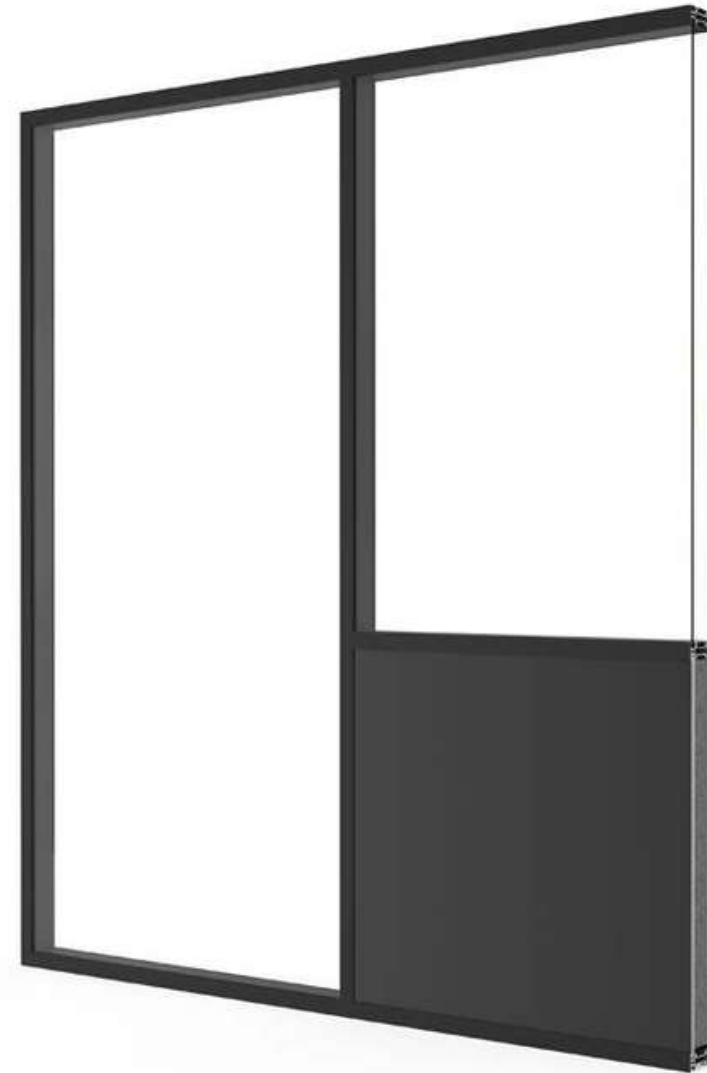

Consult maximum weight and dimensions according to typologies

BALUSTRADES



BALUSTRADE

View Crystal / View Crystal Plus

Enjoy excellent views without any visual obstacle thanks to this balustrade system based on a “U” shaped aluminium profile on which laminated safety glass is fixed. Possibility of led strip illumination and drainage solution for exposed areas. Option of aluminium embellishing profile on the upper edge.

VIEW CRYSTAL: Resists a load of 1,0 kN/m applied at 1,1 metres from its bottom part. Suitable for use in areas A1, A2, B, C1, C2, D1, D2, G1 and G2, included in the CTE DB SE-AE, and A, B, C1, C2, C3, C4, D and E, in accordance with Eurocode 1.

VIEW CRYSTAL PLUS: Resists a load of 3,0 kN/m. Suitable for use in all areas from CTE DB SE-AE and areas A, B, C1, C2, C3, C4, C5, D and E, in accordance with Eurocode 1.

AE



Assembly Possibilities

- Over slab
- Flush over slab
- Edge slab
- Inverted edge slab
- Flush with the slab
- Flush with the pavement

Maximum Height

1100 mm

Tests according to standards UNE 85237, UNE 85238 and UNE 85240. Established requirements in CTE (DB SU-1 and DB SE-AE) And established requirements in Eurocode 1 according to EN 1991-1-1/AC

Static horizontal test towards the exterior

Static horizontal test towards the interior

Dynamic test with mild object

Dynamic test with hard object

Verification of section 3.2 of DB-SE-AE of CTE

Verification of the specifications of the Eurocode 1 according to table 6.12 for use categories of 3kN/m

Classification according to UNE 85240, Class A-Excellent

Reference test on balustrade with glass and extruded aluminium, fixed to the slab edge with (H) 1100 X (L) 1500 mm of total dimensions above ground level

Reference test on balustrade with glass and extruded aluminium, fixed over the slab with (H) 1100 X (L) 1500 mm of total dimensions above ground level.

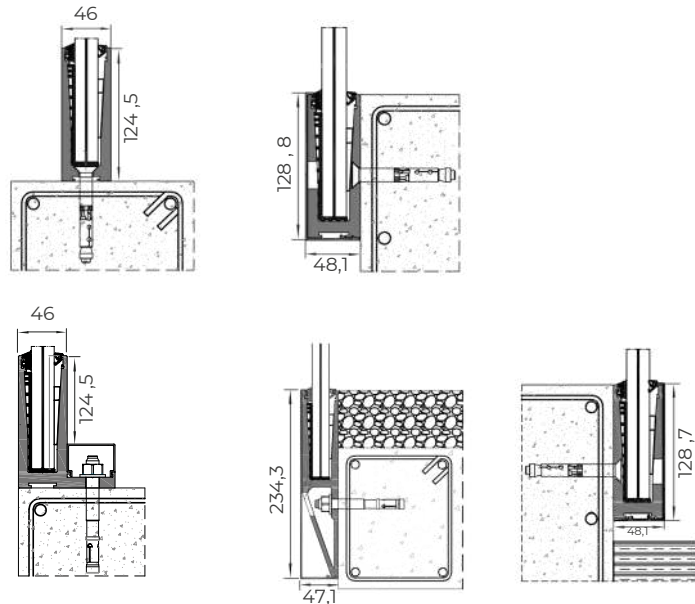

LAMINATED GLASS COMPOSITIONS

| | | | |
|------------|------------|------------|------------|
| 10-1,52-10 | 10-1,14-10 | 10-0,76-10 | 10-0,38-10 |
| 8-1,52-8 | 8-1,14-8 | 8-0,76-8 | 8-0,38-8 |
| 6-1,52-6 | 6-1,14-6 | 6-0,76-6 | 6-0,38-6 |

VIEW CRYSTAL BALUSTRADE



BALUSTRADE

Classic



Traditional balustrade system with bar or glass aspect. Possibility of fixing to slab or to the edge of the slab.

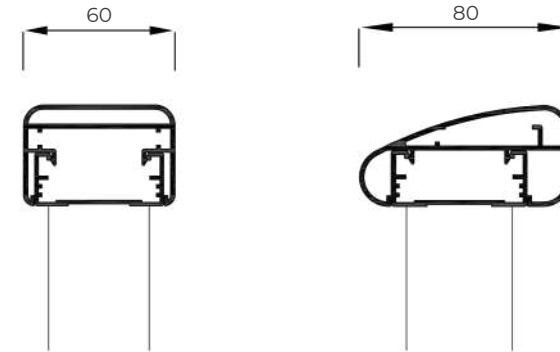

Possibilities

- Glass balustrading
- Glass balustrading with free top edge
- Bar balustrading
- Bar balustrading with free top edge

Handrail Possibilities

- Square - 60 mm width
- Circular - 66 mm diameter
- Elliptical - 80 mm external perimeter

Maximum Dimensions Between Pilasters

1000 mm

Minimum Height

900 mm

Tests according to standards UNE 85237, UNE 85238 and UNE 85210.

Requirements established in CTE (DB SU-1 and DB SE-AE)

- Static horizontal test towards the exterior
- Static horizontal test towards the interior
- Static vertical test
- Dynamic test with mild object
- Dynamic test with hard object
- Verification of section 3.2 of DB-SE-AE of CTE
- Security test

Classification according to UNE 85240, Class A-Excellent

- Reference test on glass balustrading at a total height of (H) 1100 x (L) 2450 mm and 3 pilasters.
- Reference test on bar balustrading with top free edge of (H) 1100 x (L) 2000 mm and 3 pilasters.

CLASSIC BALUSTRADE



Balustrading solution for installation on the exterior of the carpentry by means of concealed fixings, allowing for the total opening of balconies without the risk of falling.

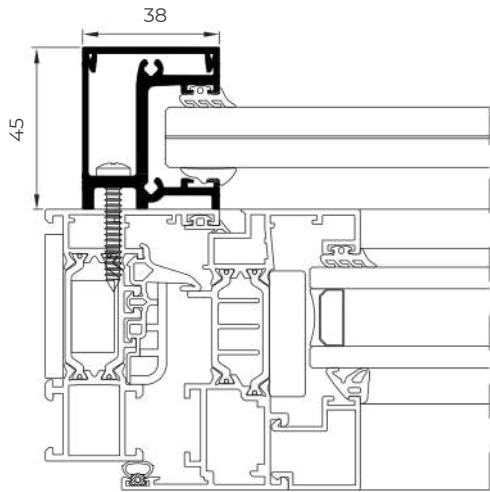

Classification according to UNE 85240, Class A-Excellent

Reference test on glass and extruded aluminium balustrade of (H) 1200 x (L) 1800 mm.

Tests according to standards UNE 85237, UNE 85238 and UNE 85240.
Requirements established in CTE (DB SU-1 AND DB SE-AE) and in Eurocode 1 according to EN 1991-1-1 for use category of up to 1,6 KN/m.

- Static horizontal test towards the exterior.
- Static horizontal test towards the interior.
- Static vertical test.
- Dynamic test with mild object.
- Dynamic test with hard object.
- Verification of section 3.2 of DB SE-AE of CTE.
- Security test.

LAMINATED GLASS COMPOSITIONS

8-1,52-8 6-1,52-6

8-1,14-8 6-1,14-6

8-0,76-8 6-0,76-6

8-0,38-8 6-0,38-6

Maximum width

1800 mm



JULIET
BALCONY

GLASS



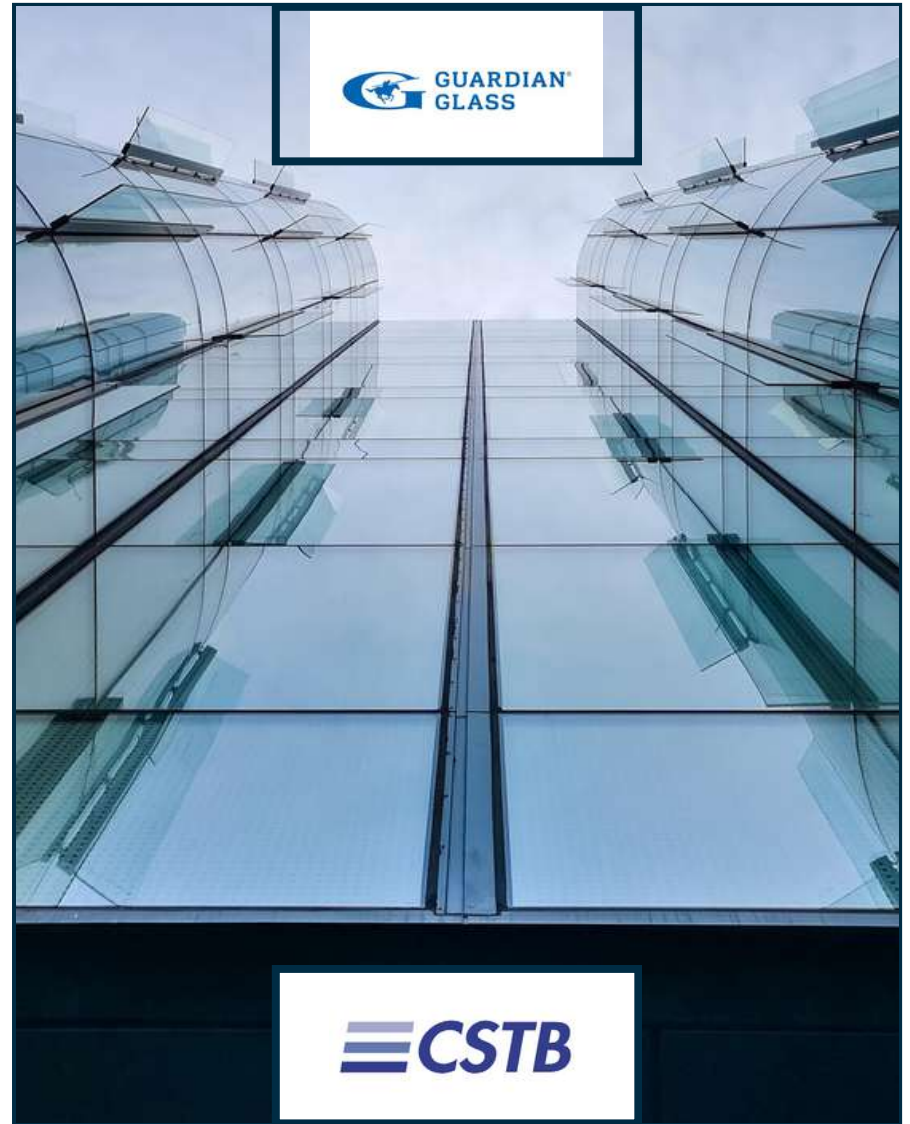
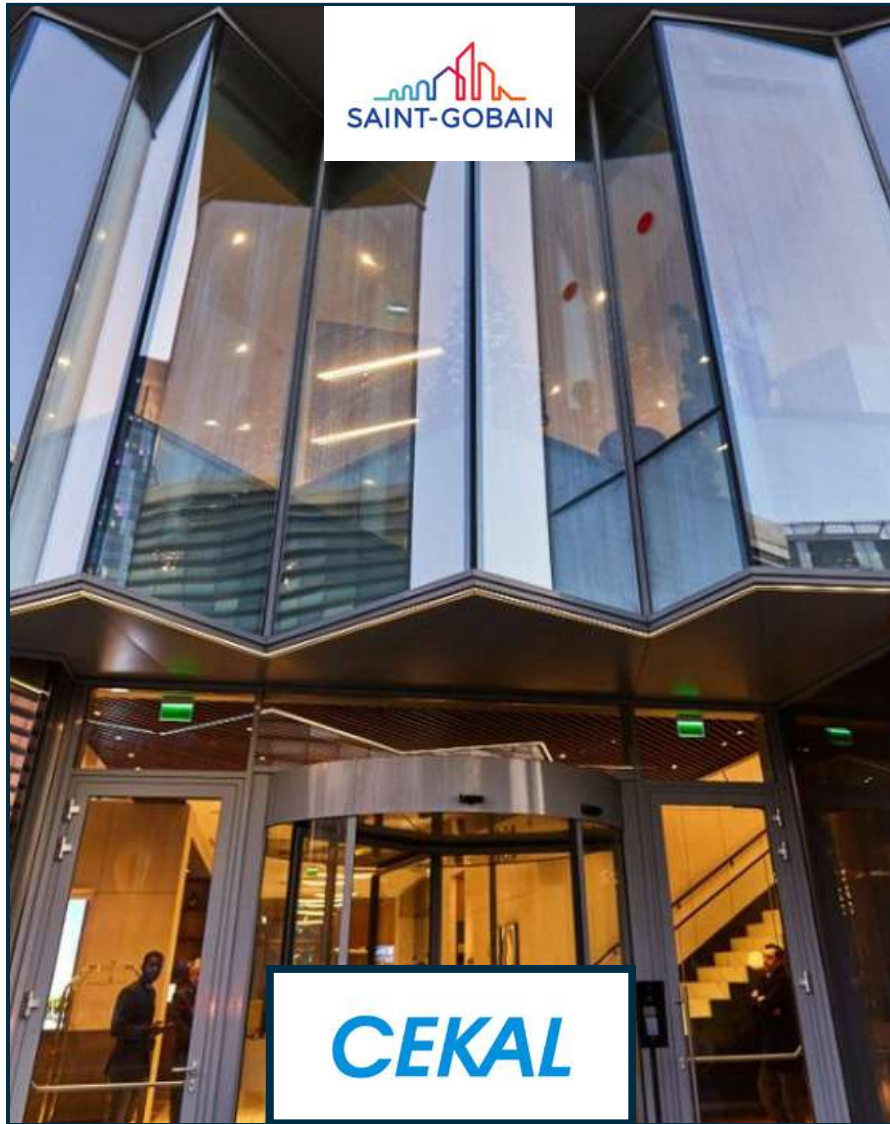

GARAGE DOORS



GARAGE DOORS

ROLL-UP

Simple and aesthetically pleasing, they are made of 55mm or 77mm wide aluminium slats filled with polyurethane foam (similar to aluminium outer rollers), providing thermal insulation and strength. This type of door is operated by rolling the door leaf mat on the guide system in a cassette mounted on top of the opening.

Possibility of motorization:



GARAGE DOORS

SECTIONAL

The sectional door consists of panels hinged together; when the sectional door opens, the panels slide vertically under the garage ceiling. It is therefore less bulky than an overhead door.

A sectional door is also easy to insulate and therefore reduces energy losses.

Possibility of motorization:

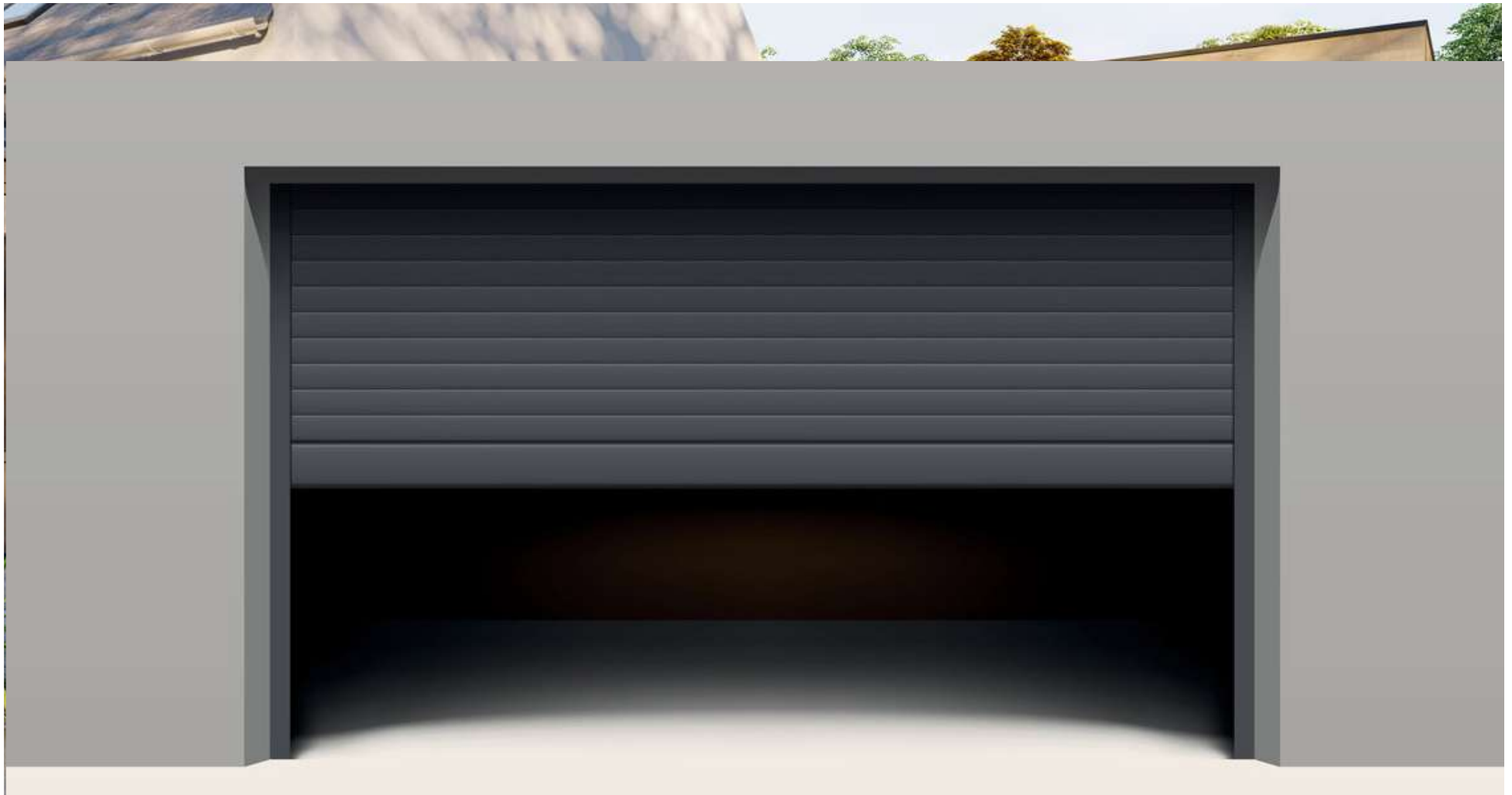

PORTE ROYALE



art
ARTA

MADE IN ITALY

PORTE ROYALE

7* COLLECTION

Standard equipment:

- 5-point locking RC2
- Day-night lock
- Security bolt
- PureHandle exterior handle
- Anti-burglary glass 73mm
(442 frosted + 442 LowE + 442 frosted) + Argon
- Decorative panel 80mm
- Sheet thickness: 2mm interior / 3mm exterior
- 3 cylindrical hinges
- PureHandle interior handle
- Thermal insulation ≥ 1.0 (W/m²K)
- Sound insulation up to 38 dB
- Minimum width = 850mm / maximum width= 1100mm
- Minimum height = 2000mm / maximum height = 2200mm

Custom Design:

- Colors: RAL color palette/ Wood imitation / Bicolor possibility
- Glass sandblasting with pattern
- Special exterior handle
- Additional aluminum milling and inserts
- Full finish in wood imitation shades

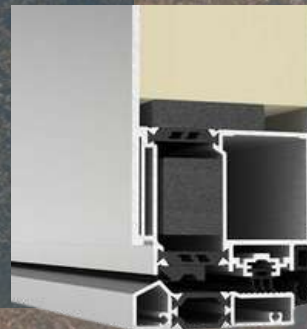

PORTE ROYALE

5* COLLECTION

Standard equipment:

5-point locking RC2

Day-night lock

Security bolt

PureHandle exterior handle

Saint Gobain triple glass:

(442 frosted + 442 LowE + 442 frosted) + Argon

Decorative panel 44mm

Sheet thickness: 2mm interior / 3mm exterior

3 cylindrical hinges

PureHandle interior handle

Thermal insulation ≥ 1.4 (W/m²K)

Sound insulation up to 38 dB

Minimum width = 850mm / maximum width = 1100mm

Minimum height = 2000mm / maximum height = 2200mm

Custom Design:

Colors: RAL color palette / Wood imitation / Bicolor possibility

Glass sandblasting with pattern

Additional aluminum milling and inserts

Full finish in wood imitation shades



PORTE ROYALE

3* COLLECTION

Standard equipment:

- 5-point locking RC2
- Day-night lock
- Security bolt
- STAC interior/ exterior handle
- 4 frosted + 4 LowE + Argon glass
- Sheet thickness: 1.2mm interior / 1.2mm exterior
- 3 cylindrical hinges
- Thermal insulation ≥ 1.5 (W/m²K)
- Sound insulation up to 32 dB
- Minimum width = 850mm / maximum width= 1100mm
- Minimum height = 2000mm / maximum height = 2200mm

Custom Design:

- Colors: RAL color palette / Bicolor possibility
- Additional aluminum milling and inserts

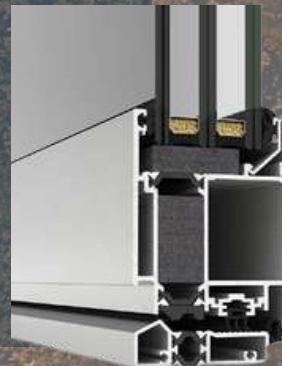

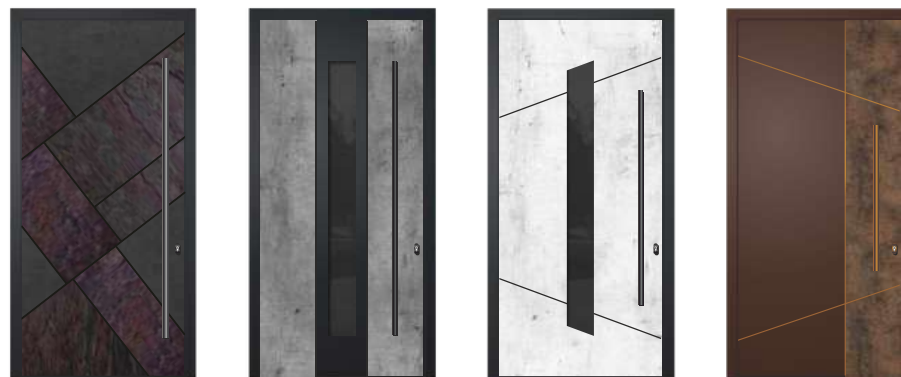

ARTA

NATURA





MINIMALISTA





CONTEMPORANEO





MONARCA





CLASSICO



ACCESSORIES



VENTILATION GRILLES

INVISIVENT AIR LIGHT (ALU)

With this new range, the focus is on energetic, acoustic, and thermal comfort. These products guarantee a fast installation (monobloc principle), high stability on the window and a totally airtight finish. The Invisivent Air can easily be used in any project, be it a new build or renovation project. The Invisivent AIR Basic guarantees a basic sound damping of 34(0;-1) dB.



AIRFLOW CONTROLLER CANOPY (PVC)

Beyond protecting the interior of the window from water infiltration and volatile insects, the AC external canopy also controls the airflow to avoid over-ventilation in case of excess of pressure through a patented device. This ability makes the AC canopy particularly suitable for tall buildings or windy locations. The AC external canopy can be installed with either fixed or humidity sensitive air inlets.



SCREENS FOR WINDOWS

INSECT SCREENS - VERTICAL ROLLER TYPE B'SMART

Front view



Side view



Profile section

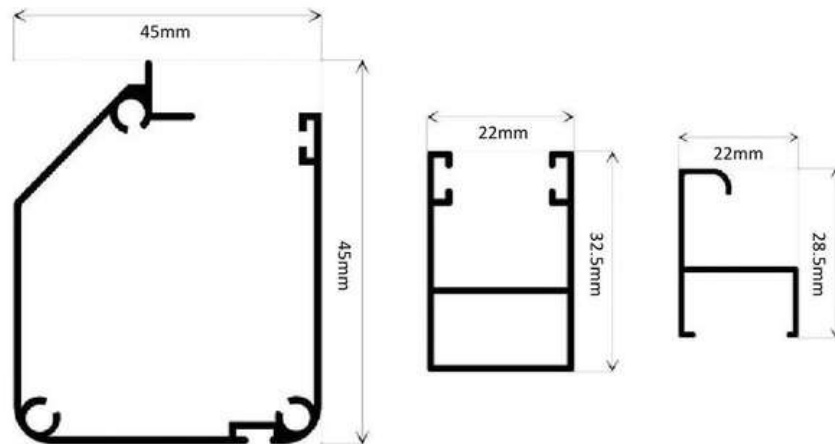

Constructive possibilities:

Maximum execution dimensions L 180cm x H 270cm

Screen mesh in gray or black color

Hermetic closure along the bottom profile

Anti-draft brush

Braking system upon screen opening

Hard plastic handles

Mounting screw kit

Profile painting in RAL shades or wood imitation

Renolit foil wrapping

White

Brown

Golden Oak



SCREENS FOR WINDOWS

INSECT SCREENS - HORIZONTAL ROLLER TYPE B'SMART

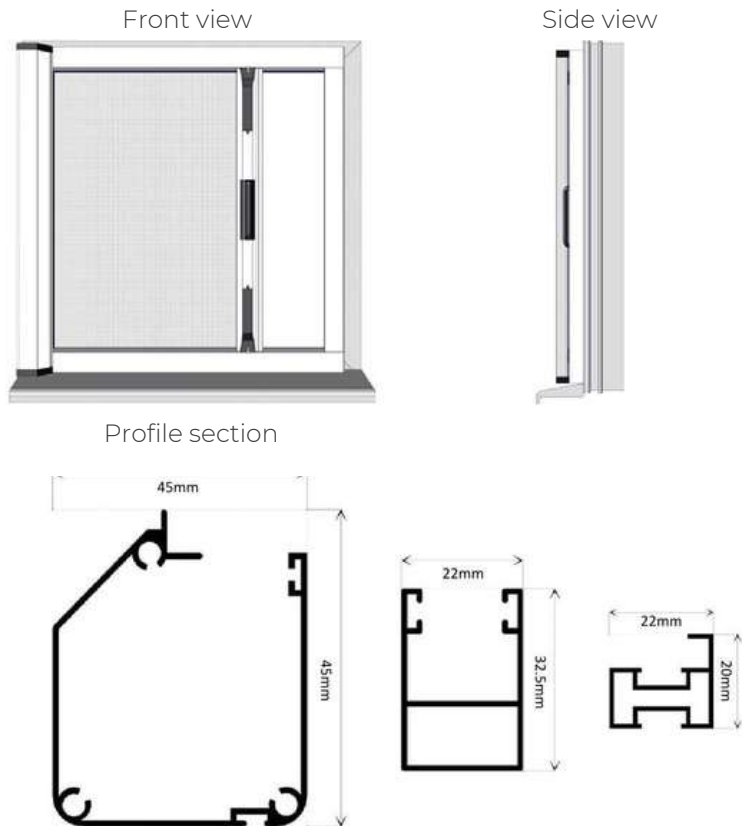

Constructive possibilities:

- Maximum execution dimensions L 180cm x H 270cm
- Screen mesh in gray or black color
- Hermetic closure with magnet
- Guiding rolls
- Anti-draft brush
- Braking system upon screen opening
- Hard plastic handles
- Mounting screw kit
- Profile painting in RAL shades or wood imitation
- Renolit foil wrapping

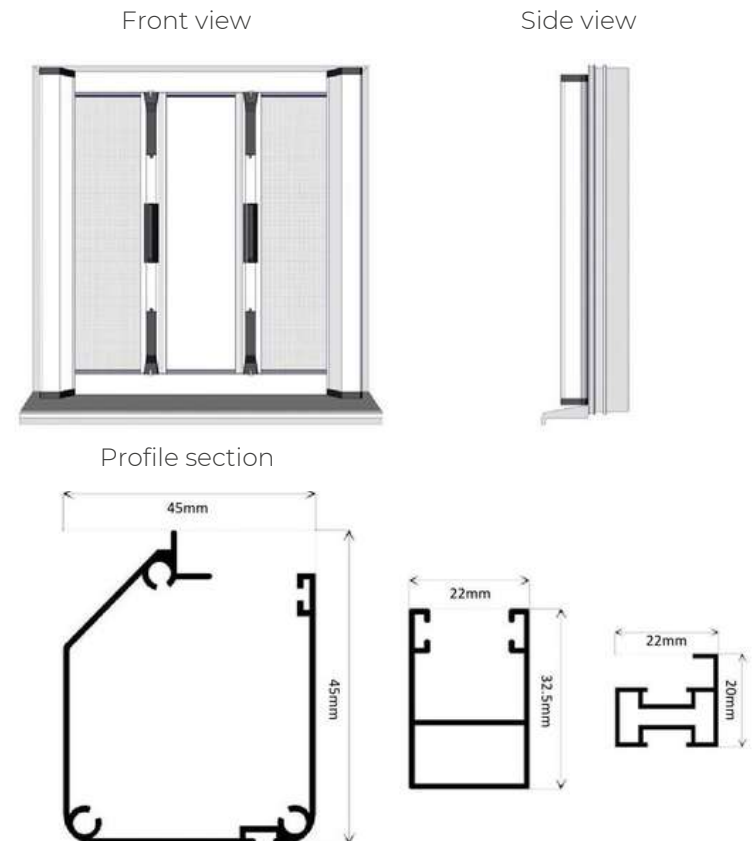

Constructive possibilities:

- Maximum execution dimensions L 240cm x H 270cm
- Screen mesh in gray or black color
- Hermetic closure with magnet
- Guiding rolls
- Anti-draft brush
- Braking system upon screen opening
- Hard plastic handles
- Mounting screw kit
- Profile painting in RAL shades or wood imitation
- Renolit foil wrapping

SCREENS FOR WINDOWS

INSECT SCREENS - TYPE B'SMART PLISSE

Front view



Side view

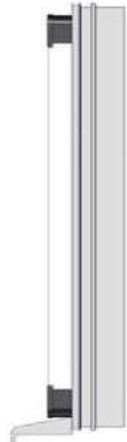

Profile section

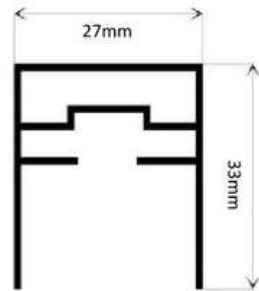
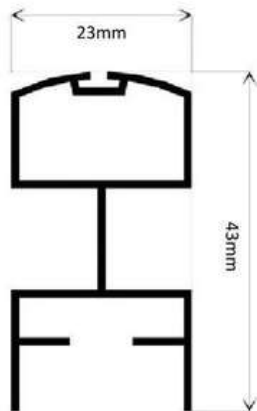

Constructive possibilities:

Maximum execution dimensions L 200cm x H 300cm

Screen mesh in gray or black color

Sectional profile equipped with mounting area

Hermetic closure with brush

Durable plastic accessories

Mounting screw kit

Execution with 6mm threshold

Profile painting in RAL shades or wood imitation

Renolit foil wrapping

White (RAL 9010)

Brown (RAL 8014)

Brown (RAL 8019)

Antracite Gray (RAL 7016)

Golden Oak



SCREENS FOR WINDOWS

INSECT SCREENS - TYPE B'SMART PLISSE

Front view



Side view

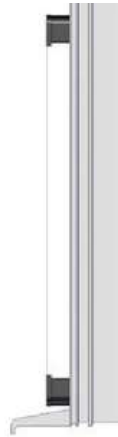

Profile section

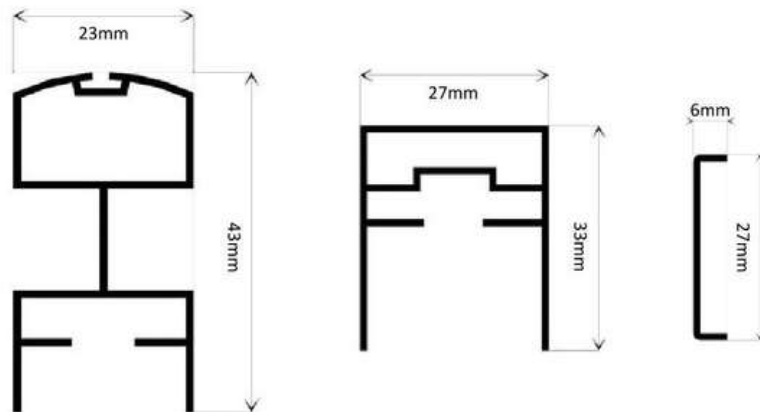

Constructive possibilities:

Maximum execution dimensions L 600cm x H 300cm

Screen mesh in gray or black color

Sectional profile equipped with mounting area

Hermetic closure with magnet

Durable plastic accessories

Mounting screw kit

Execution with 6mm threshold

Profile painting in RAL shades or wood imitation

Renolit foil wrapping

White (RAL 9010)

Brown (RAL 8014)

Brown (RAL 8019)

Antracite Gray (RAL 7016)

Golden Oak



CONTACT



DN1 - E60, Km 488 + 300 Luna de sus, Florești, Cluj, Romania

(+40) 371 38 40 50

contact@termoexpress.com

www.termoexpress.com

